



4-CYLINDER HYDRAULIC BOAT LIFT MANUAL



LIFT MODELS

<i>PH-8K-6</i>	<i>PH-11K-4</i>	<i>PH-13K-4</i>	<i>PH-15K-6</i>
<i>PH-10K-5S</i>	<i>PH-10K-5</i>	<i>PH-12K-5</i>	<i>PH-20K-6</i>
<i>PH-10K-6S</i>	<i>PH-10K-6</i>	<i>PH-12K-6</i>	

Paradise Dock & Lift
4311A 25 Avenue
Vernon, BC, Canada
V1T 1P5

Office: 236-426-3625
Toll Free: 1-888-411-3625
info@paradisedocklift.com
www.paradisedocklift.com

Issued: 2024-08-14

COPYRIGHT © 2024
PARADISE DOCK & LIFT INC

Paradise Dock & Lift

We are honored you have chosen a Paradise boat lift to protect your watercraft and enhance your experience getting on and off the water.

Our hydraulic boat lifts are built using only the highest quality 6061-T6 marine grade aluminum and stainless steel hardware. All non-adjustable components are welded to enhance ease of installation and to reduce the chance of components loosening. Our proprietary stainless steel cylinders patented-design ensures they are fully protected and retracted when in the up-position (where the lift lives 95% of the time) and allows for extra depth clearance with blow-ins when required. This configuration ensures maximum cylinder life by preventing rod corrosion, pitting, and marine growth while increasing the seal life - which is the most common source of failure on hydraulic cantilevered lifts. Our quality hydraulic fluid is non-toxic and biodegradable, so you don't need to worry about environmental harm. We've worked hard to design and manufacture the strongest, most reliable boat lift possible, and look forward to serving you for many years on the water.

We deeply value the opportunity to elevate your waterfront experience!



*Yanek Buksowicz, Owner
and the entire Paradise Dock & Lift team*

Table of Contents	1
Safety Information	2
Liability Disclaimer.....	3
Specifications.....	4
Component Overview	6
Assembly Instructions	8
Installation	24
Remote Control.....	26
Maintenance	27
Troubleshooting	28
Warranty	29



Always read and obey all safety messages and instructions when assembling, installing or operating the boat lifting system. Boat lifts are heavy equipment that pose major hazards. Your safety is of utmost importance, so if there is any misunderstanding with information contained in this manual, please contact your dealer or the manufacturer. Important safety messaging will be outlined as follows:



DANGER! Failure to follow instructions **WILL** result in serious injury or death.



CAUTION! Failure to follow instructions **CAN** result in serious injury or death.



WARNING! Failure to follow instructions/take appropriate actions **COULD** result in serious injury, death, and/or property damage.

Note:

Paradise Dock & Lift Inc reserves the right to make changes to this product and manual at any time without notice. This manual includes the latest information at the time it was printed and the product was shipped. This manual should be kept available to whoever is using this product.



DANGER!

- Never allow any persons to go under or on the lift, particularly when it is operating or supporting a load.
- All persons must stay clear of lift while the lift is in operation.
- Never service a boat lift, boat or boat lift accessory while the lift is supporting a load.
- Your lift system is not intended to support people. Never actuate the lift with people on-board. Unload and load passengers only when the boat is floating and not supported by the lift.
- Never exceed the lift's rated capacity. The gross/loaded weight of your watercraft should always be less than the lift capacity.



STAY CLEAR!



DO NOT RIDE LIFT!



CAUTION!

- Only operate the system to lift the watercraft, do not use the system for other purposes or items.
- The lift should only be operated by adults or under direct adult supervision. Anyone who operates the lift must be fully aware of the information outlined in this manual.
- Do not play on or around the lift.
- It is not possible for the manufacturer to identify all hazards surrounding the site assembly, installation and operation of a lift system. Owners, dealers, and installers must use good judgement to assess risk, and make installation, maintenance, and operation decisions: Do not operate in poor conditions, when system is not level, or when noticeable corrosion/damage/defects are present.
- Failure to properly position boat on lift could make the lift unstable.
- Keep long hair, loose clothing, and jewelry away from any moving parts.

LIABILITY DISCLAIMER



Installation and assembly instructions provided are intended for authorized Paradise Dock & Lift dealers and installers. If you require assistance, please contact Paradise Dock & Lift to be put in contact with a dealer in your area who can safely assemble and install this system. An installer must determine if they have the necessary experience, knowledge and skills to safely assemble and install a lift system. If there is any confusion, please contact Paradise Dock & Lift. Improper assembly and/or installation may cause a risk to property, safety or lift functionality/reliability. A failure to correctly follow assembly and installation instructions constitutes a waiver of the installer's rights against Paradise Dock & Lift Inc. for subsequent damages. The installation instructions provided are not a warranty or guarantee; best judgement must be used during installation.

Many boats (catamarans, v-hull, pontoon, tritoon, etc) require custom supports and/or bunk configurations. Any watercraft should be supported as per boat manufacturer recommendations, and installers should contact the boat manufacturer to verify. Incorrect and inadequate support may result in damage to the boat. Paradise Dock & Lift cannot determine, guarantee, warrant or take responsibility for bunk/support configurations meeting each manufacturer's recommendation.



CAUTION!

- **During the first few operations of the lift, the weight of the watercraft may cause the lift to settle. Stay well away from the lift during actuation until it is seen that the installation is stable.**
- **The frame structure, welds, bolt and pin conditions should be inspected for issues such as corrosion and wear annually.**
- **Do not store items in the power pack box; items may damage hydraulic and electrical systems.**



WARNING!

- **Leave the lift in the fully "up over centre" position during storage. This is the safest position.**
- **Do not position the lift near areas where people swim or dive frequently. When it is lowered, swimmers may inadvertently hit the lift causing injury.**
- **Ensure that the lift remains level within 2 inches . Out-of-level lift installations may be unstable, and increase the risk of capsizing and injury.**
- **Never disconnect hydraulic hoses with a watercraft on the lift.**
- **Never enter the lift while the boat is under power. Glide in at a slow speed. The lift is not designed to take large impacts from a fast moving boat. Large impacts may cause damage to the lift.**
- **It is recommended that the lift be partially raised out of the water if people are swimming in the vicinity. Use the remote to raise the lift when departing so swimmers can see the location of the boat lift.**

Factory Specifications				
Model	<i>PH-8K-6</i>	<i>PH-11K-4</i>	<i>PH-10K-5</i>	<i>PH-10K-6</i>
Rated Capacity	8000 lbs (3629 kg)	11 000 lbs (4990 kg)	10 000 lbs (4536 kg)	
Cylinder Quantity	4			
Lift Range	6ft (72 in)	4ft (48 in)	5ft (60 in)	6ft (72 in)
Approximate Weight	1065 lbs (483 kg)	1125 lbs (510 kg)	1159 lbs (526 kg)	1181 lbs (536 kg)
Frame Length (Raised)	14.85 ft (178.15 in)	16.85 ft (202.15 in)		
Frame Width (Raised)	10.58ft (127 in)			
Bunk Length *	12.5 ft (150 in)	14.5 ft (174 in)		
Battery	2x12V-DC Deep Cycle Battery [†] (24V system)			
Battery Charger	120 Watt 24V Plug-in Trickle Charger [‡]			
Construction	Welded 6061-T6 Aluminum			
Pins	17-4PH Stainless Steel			
Fasteners/ Hardware	18-8 Stainless Steel			
Hose Length	196 in [¶]			
Power Pack	4KW Hydraulic Pump/Power Pack, enclosed in fiberglass lock boxes, operated using provided transmitter			

*Custom bunk lengths and configurations are available

† Lithium option available

‡ 50 watt solar charger available

¶ Extensions available

SPECIFICATIONS



Factory Specifications					
Model	PH-10K-5S	PH-10K-6S	PH-13K-4	PH-12K-5	PH-12K-6
Rated Capacity	10 000 lbs (4536 kg)		13 000 lbs (5897 kg)	12 000 lbs (5443 kg)	
Cylinder Quantity	4				
Lift Range	5ft (60 in)	6ft (72 in)	4ft (48 in)	5ft (60 in)	6ft (72 in)
Approximate Weight	1099 lbs (kg)	1119 lbs (508 kg)	1154 lbs (523 kg)	1188 lbs (539 kg)	1210 lbs (549 kg)
Frame Length (Raised)	14.85 ft (178.15 in)		16.85 ft (202.15 in)		
Frame Width (Raised)	10.58ft (127 in)				
Bunk Length *	12.5 ft (150 in)		14.5 ft (174 in)		
Battery	2x12V-DC Deep Cycle Battery [†] (24V system)				
Battery Charger	120 Watt 24V Plug-in Trickle Charger [‡]				
Construction	Welded 6061-T6 Aluminum				
Pins	17-4PH Stainless Steel				
Fasteners/ Hardware	18-8 Stainless Steel				
Hose Length	196 in [¶]				
Power Pack	4KW Hydraulic Pump/Power Pack, enclosed in fiberglass lock boxes, operated using provided transmitter				

*Custom bunk lengths and configurations are available

† Lithium option available

‡ 50 watt solar charger available

¶ Extensions available

COMPONENT OVERVIEW

4 Cylinder Hydraulic Boat lift Models

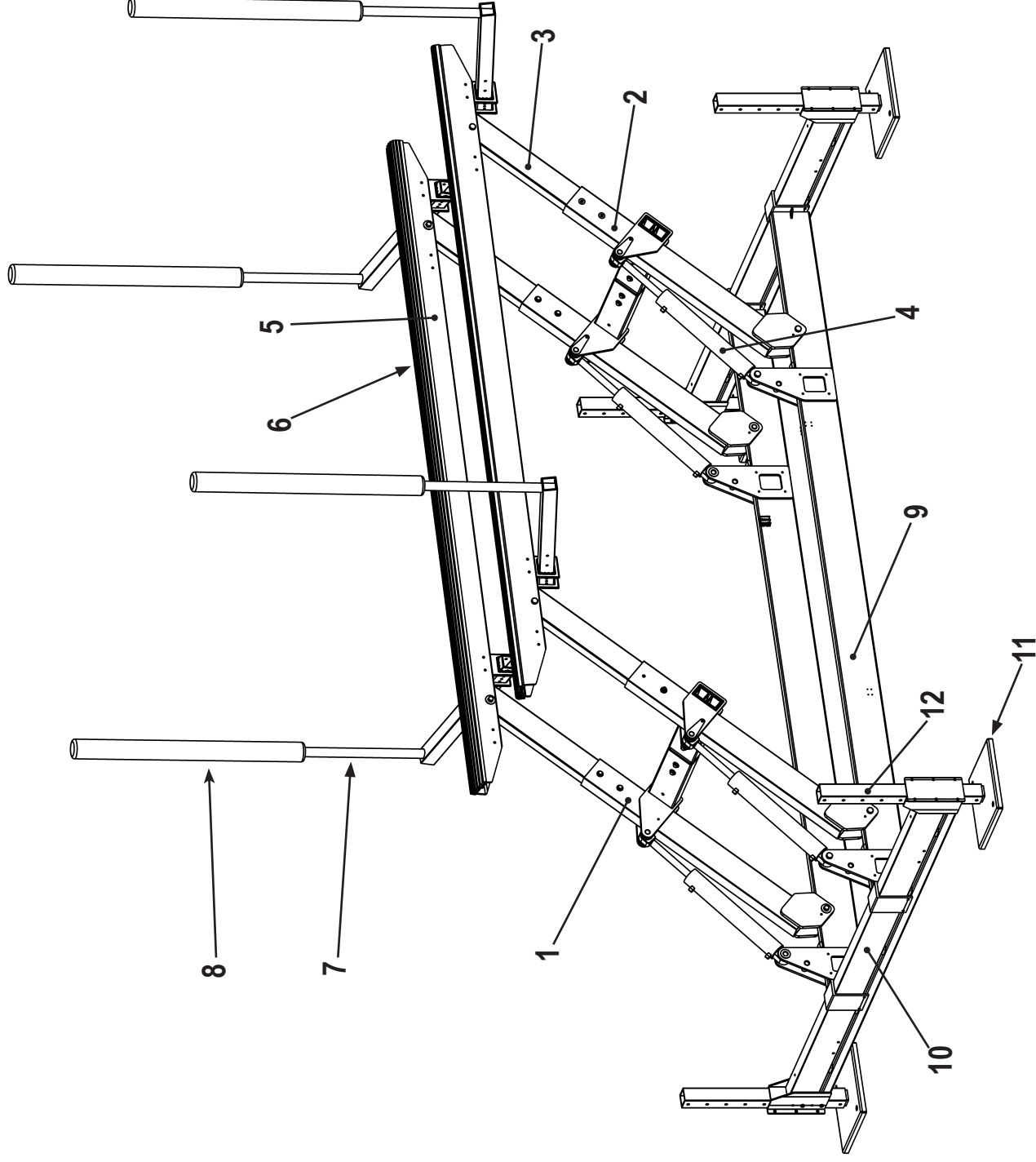

Item	Part Description	Qty	Model								
			PH-8K-6	PH-10K-5S	PH-10K-6s	PH-11K-4	PH-10K-5	PH-10K-6	PH-13K-4	PH-12K-5	PH-12K-6
1	Front H-Frame	1	S-B-FHF								
2	Rear H-Frame	1	S-B-RHF								
3	Range Extender	4	P-BEA-HFXDR-38-HH	P-BEA-HFXDR-26-HH	P-BEA-HFXDR-38-HH	P-BEA-HFXDR-14-HH	P-BEA-HFXDR-26-HH	P-BEA-HFXDR-38-HH	P-BEA-HFXDR-14-HH	P-BEA-HFXDR-26-HH	
4	Hydraulic Cylinder	4	R-BMO-HYDCYL								
5	Bunk	2	P-BEA-BUNK-150			P-BEA-BUNK-174					
6	Bunk Rubber	2	R-BER-BUNKCAP-152			R-BER-BUNKCAP-176					
7	Guide On (Optional)	4	F-PHA-GUIDES								
8	Guide On Foamie	4	P-BO-GOFOAMIE								
9	Main Beam	2	S-B-SFRMSIDE-4CYLR			S-B-LFRMSIDE-4CYLR			S-B-LFRMSIDE-4CYLXR		
10	End Beam	2	S-B-FRMEND-R						S-B-FRMEND-XR		
11	Foot Pad	4	S-B-FOOTPAD								
12	Leg Tube	4	S-BEA-LEGTUBE								
-	Cylinder Kit [not shown]	1	Includes hoses, fittings, and cylinder								
-	Power Pack [not shown]	1	Includes box, pump, battery, and charger								

Tools Required:

- 9/16" wrench, socket and ratchet
- 3/4" wrench, socket and ratchet
- 7/32" Allen key
- Needle nose pliers
- Torque wrench (20-60 ft lbs range)
- Anti seize
- Marine grease
- Rubber mallet
- Tape measure
- Pencil/pen

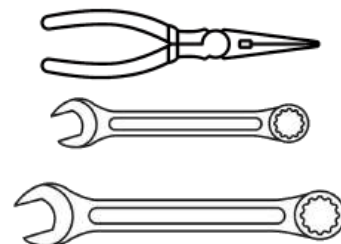

⚠ WARNING! - Follow all assembly instructions, failure to assemble lift as described may lead to warranty issues, hazards, or the lift malfunctioning.

⚠ WARNING! Apply anti-seize to ALL stainless steel bolts.

Step 1: Assemble H-frames (Item 1, Item 2, and Item 3)

Hardware Required:

- 8x 1/2"-13 - 4" Long Hex Bolts
- 16x 1/2"-13 - Nylock Nuts
- 32x 1/2" - Flat Washers

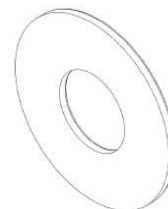
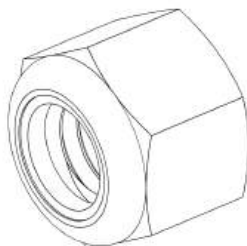
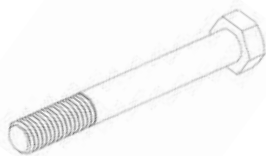

- 8x 1/2"-13 - 4 1/2" Long Hex Bolts

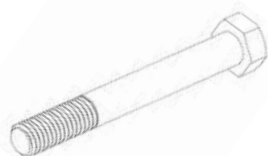

Bunk Spacing		
Reference	Standard Configuration	Expanded Configuration
Inside Edge	33.5"	39.5"
Bunk xCenter	39"	45"

Note: The center piece of the H-frames come drilled with 6 holes. The standard H-frame configuration uses the inner 4 holes. If the bunks interfere with the hull chimes, use the wider configuration. Measure the hull before assembly to determine which configuration is required.

Standard Configuration



Wider Configuration

ASSEMBLY

1-A) Using the 4" bolts, Bolt on the inner cross tubes:
(Front H-Frame shown)

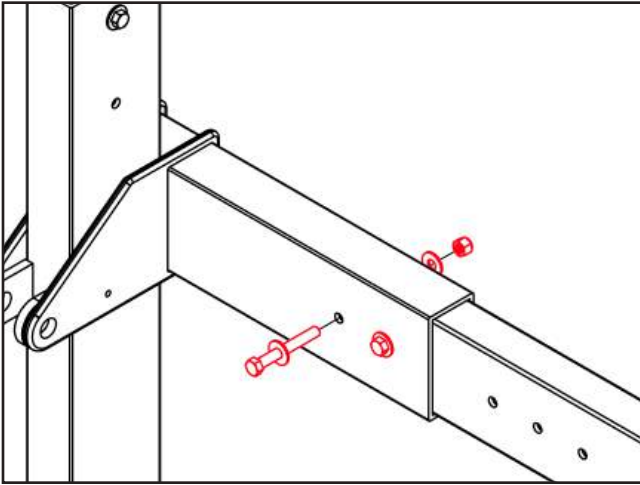

1-B) Using the 4 1/2" bolts, bolt on the range extenders (Item 3) with the bolt heads on the inside of the H-frame:

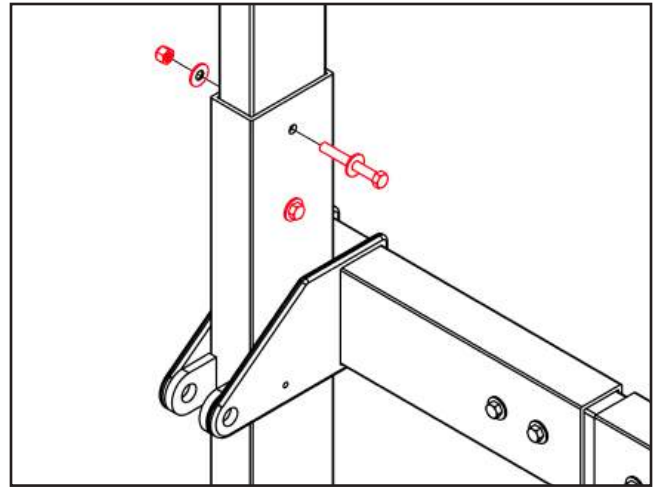

1-C) Repeat steps A-B for the other side:
(Rear H-Frame shown)

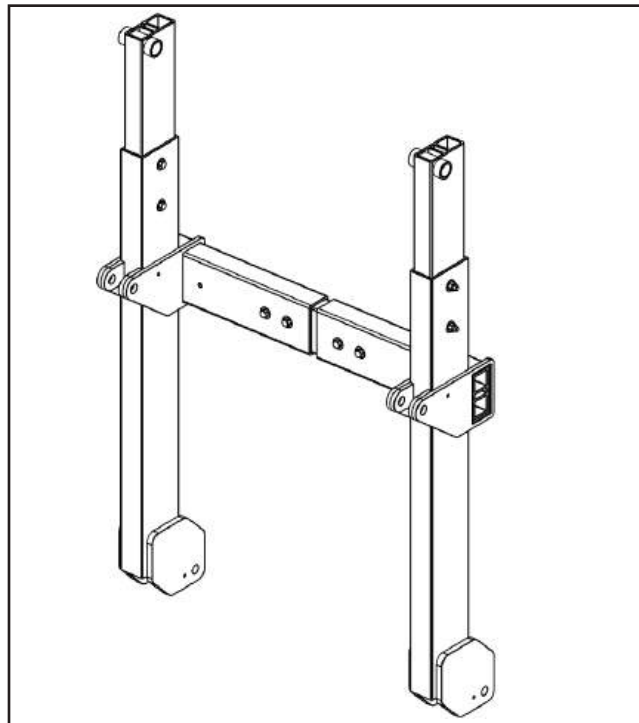

1-D) Repeat Steps A-C for both the Front and Rear H-Frame assemblies.

1-E)  Torque the bolted connections to 56 ft-lbs and mark the nuts as torqued with the torque seal/paint marker.

Step 2: Assemble the Legs (Item 12) and Foot Pads (Item 11)

Hardware required:

- 4x 3/8"-16 - 3 3/4" Long Hex Bolts
- 4x 3/8"-16 - Kep Nuts
- 4x 3/8" - Flat Washers

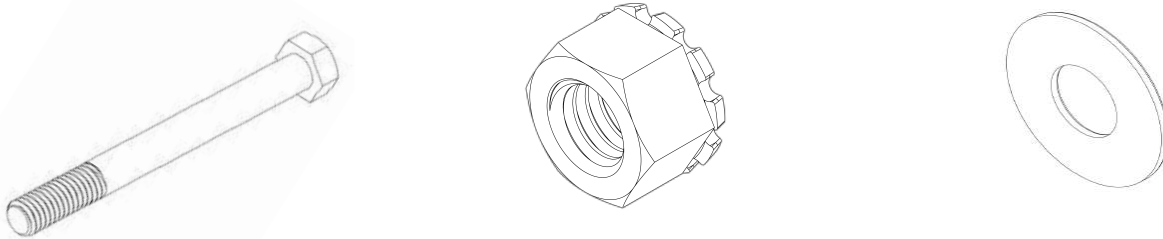

2-A) Assemble the 4 legs and 4 foot pads:

X4

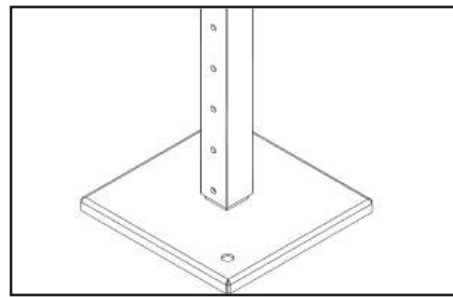
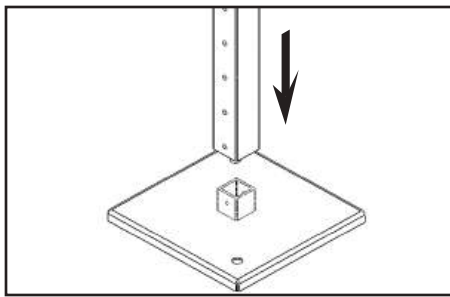

2-B) Bolt the legs to the foot pads using the 9/16" wrenches:

X4

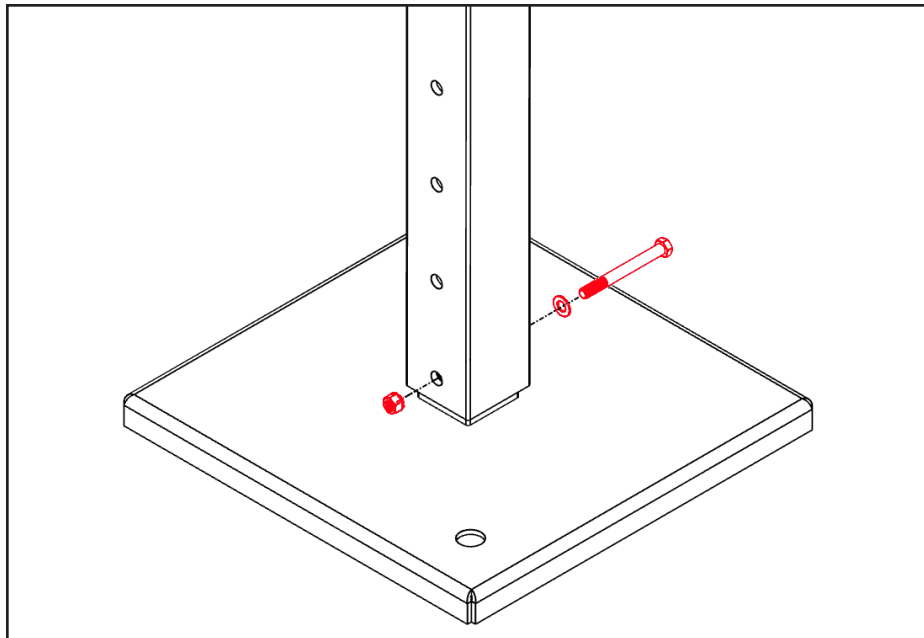

2-C)  Torque the 3/8-16 bolted connection to 23 ft-lbs.

Step 3: Assemble the End Beams (Item 10) and Legs (Item 12)

Hardware required:

- 4x 3/8"-16 - 4 1/2" Long Hex Bolts
- 4x 3/8"-16 - Kep Nuts
- 4x 3/8" - Flat Washers

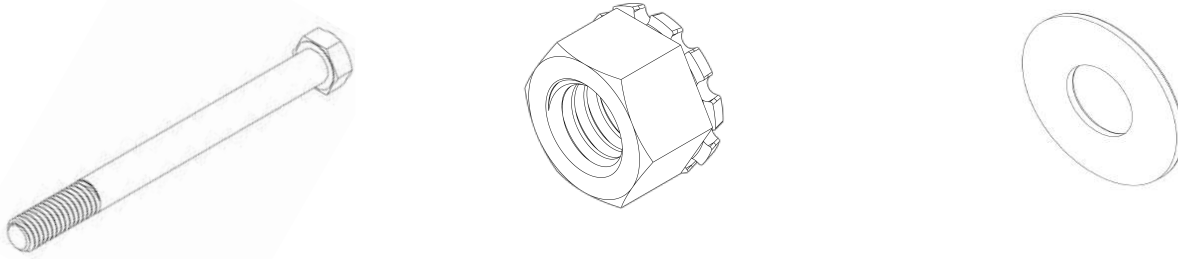

3-A) Assemble the 2 end beams on the 4 legs:

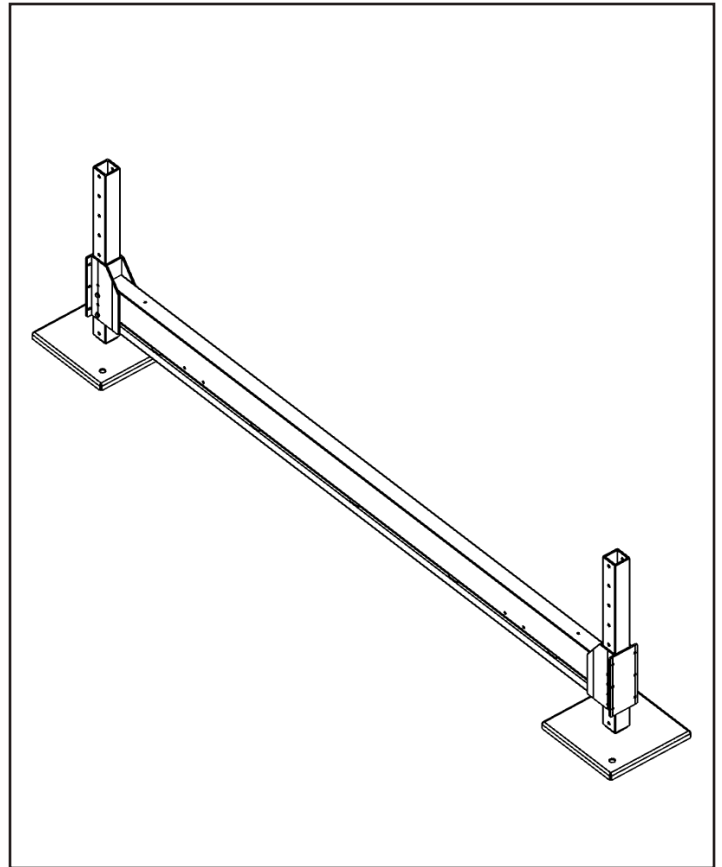
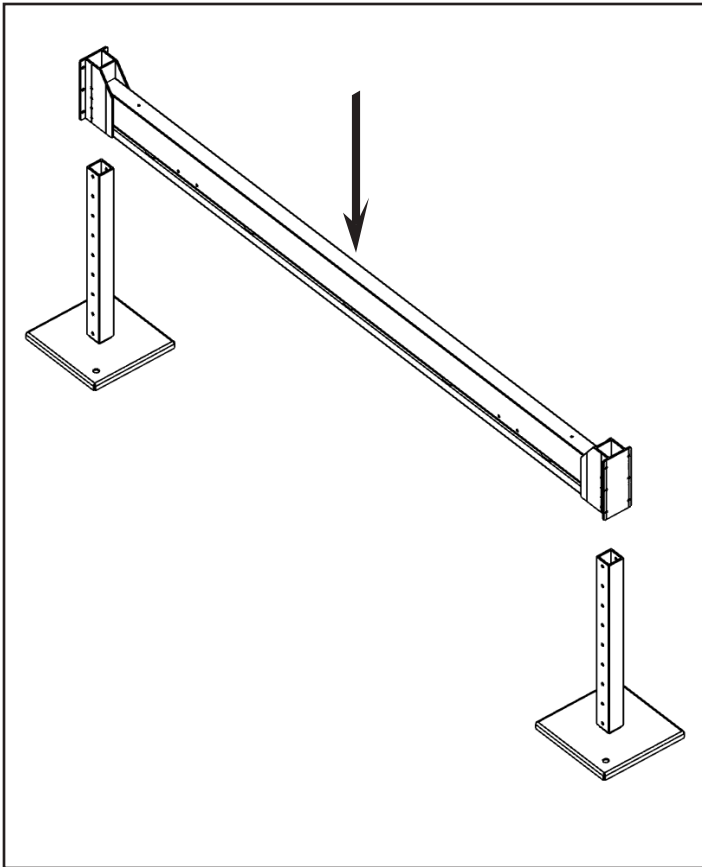

3-B) Bolt the end beams and legs together (3/8-16 bolts and 9/16" wrench for the legs). Make sure the top of the leg extends at least 1/2" past the top of the leg pocket. (illustration on next page):

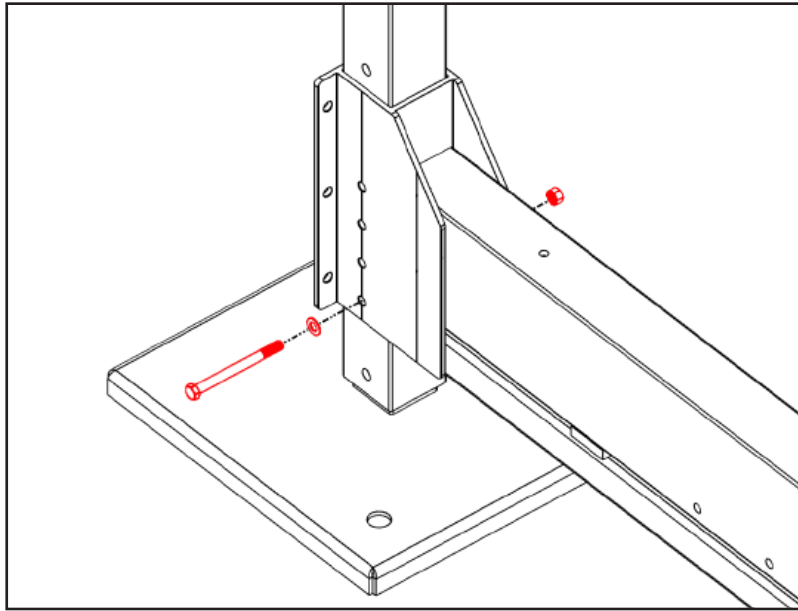

3-C)  Torque the 3/8-16 bolted connection to 23 ft-lb.

Step 4: Assemble the Main Beams (Item 9) on the End Beams

Hardware required:

- 8x 3/8"-16 - 4 1/2" Long Hex Bolts
- 8x 3/8"-16 - Kep Nuts
- 8x 3/8" - Flat Washers

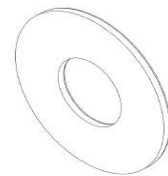
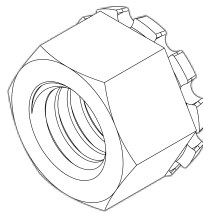
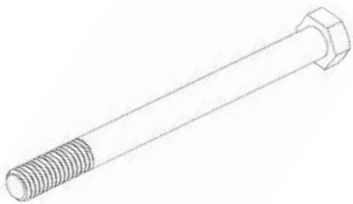

4-A) Use a tape measure and pencil to mark the approximate location of the main beams as indicated below:

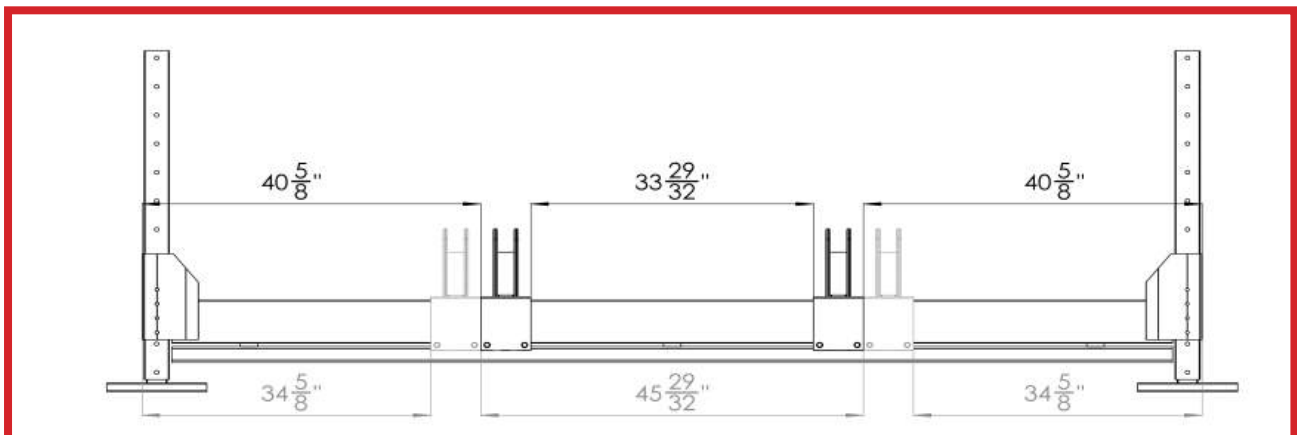

Note: Use wider spacing if bunks interfere with hull chimes

4-B) Install the main beams onto the end beams:

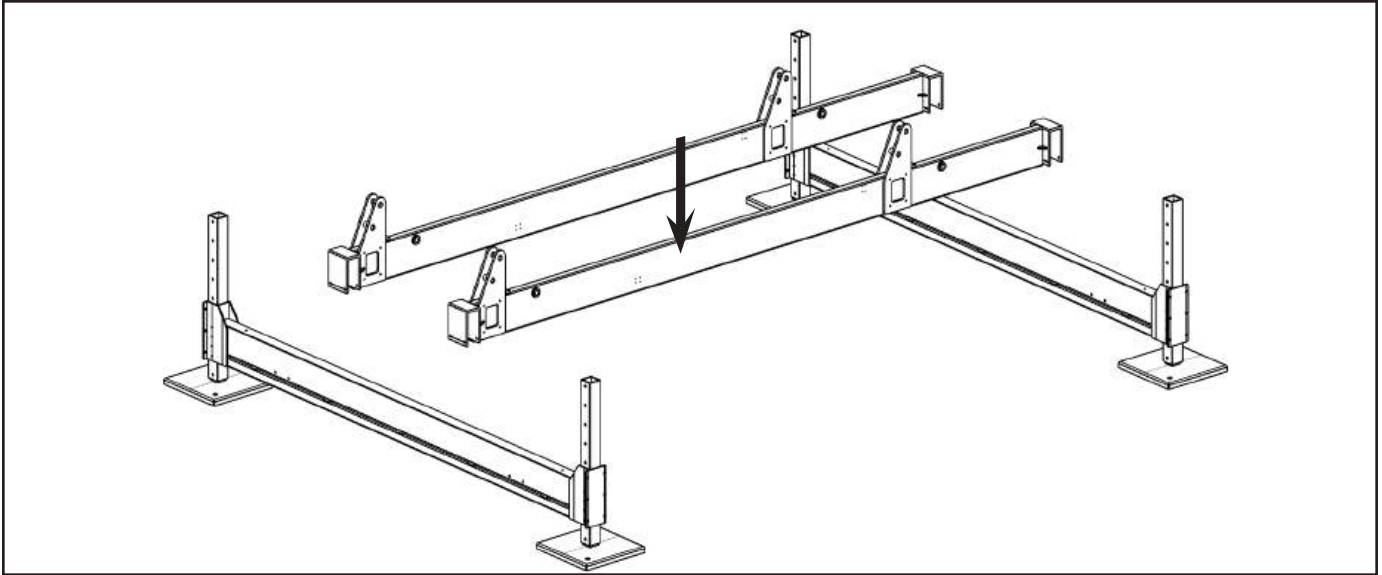

Use a square to ensure main beams are at 90 degrees to the end beams

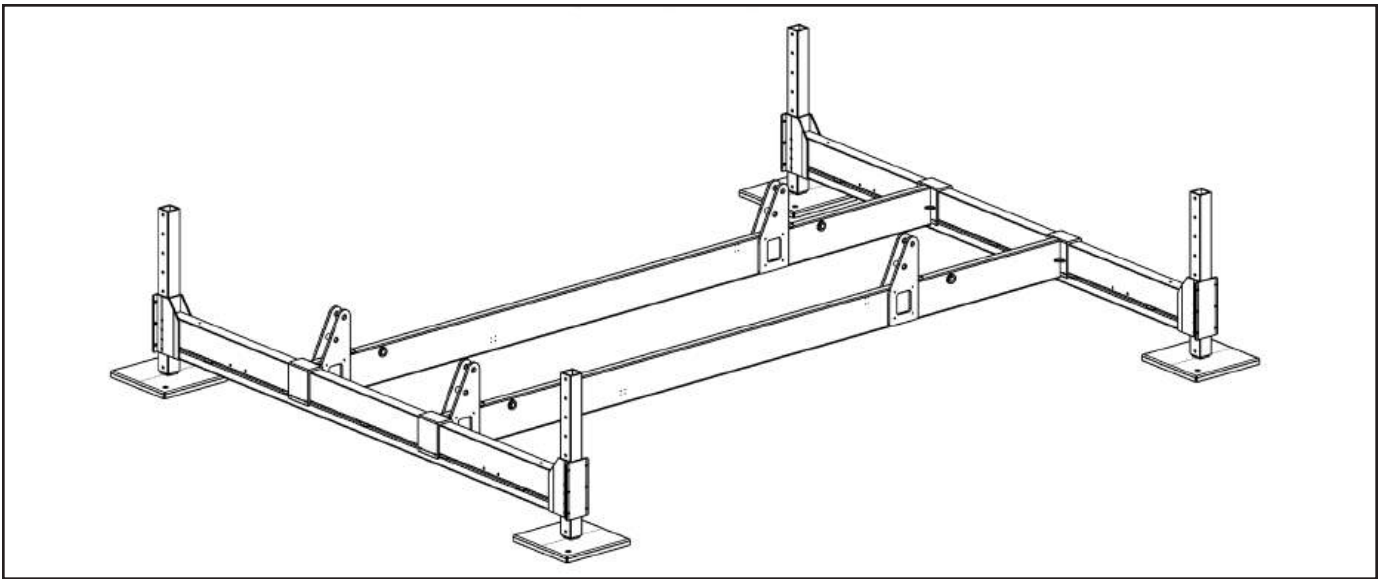

4-C) Use the 9/16" wrenches and 3/8" hardware to loosely bolt and clamp the main beams to the end beams:

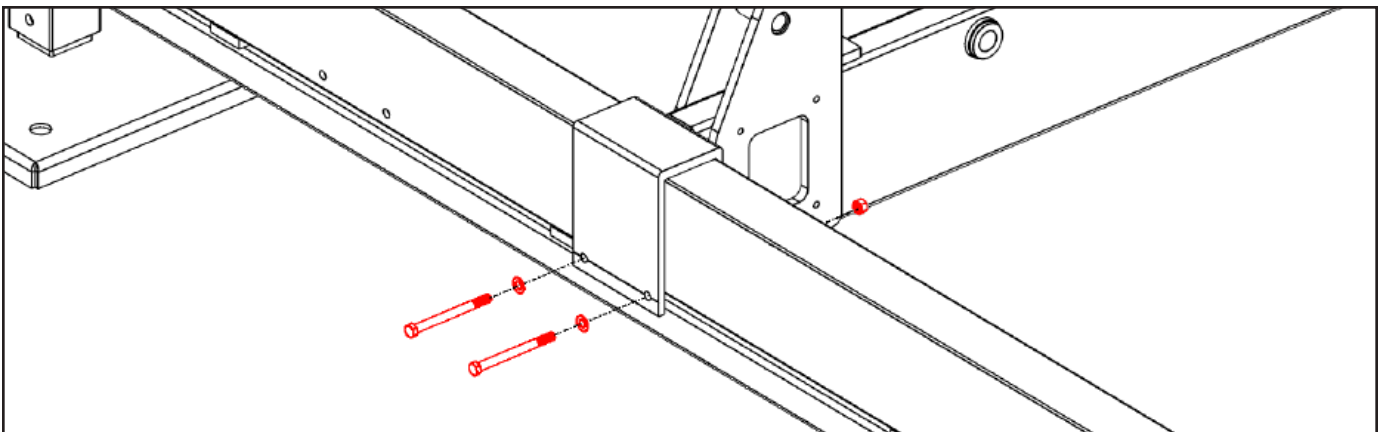

Step 5: Attach H-Frames (Item 1 & 2) to Main Beams (Item 9)

Hardware required:

- 4x Ø1" - 4 3/4" Long Pin w/ Head
- 4x Cotter Pins
- 4x 1" - Flat Washers

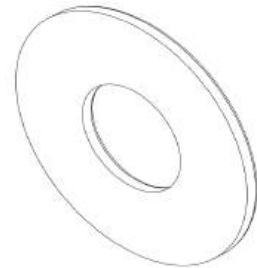
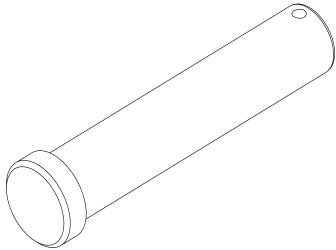

Front H-Frame



Rear H-Frame



5-A) Apply marine grease to pin assemblies.

5-B) Use the pin assemblies to attach the H-Frames (Item 1 & 2) to the main beams (Item 9).

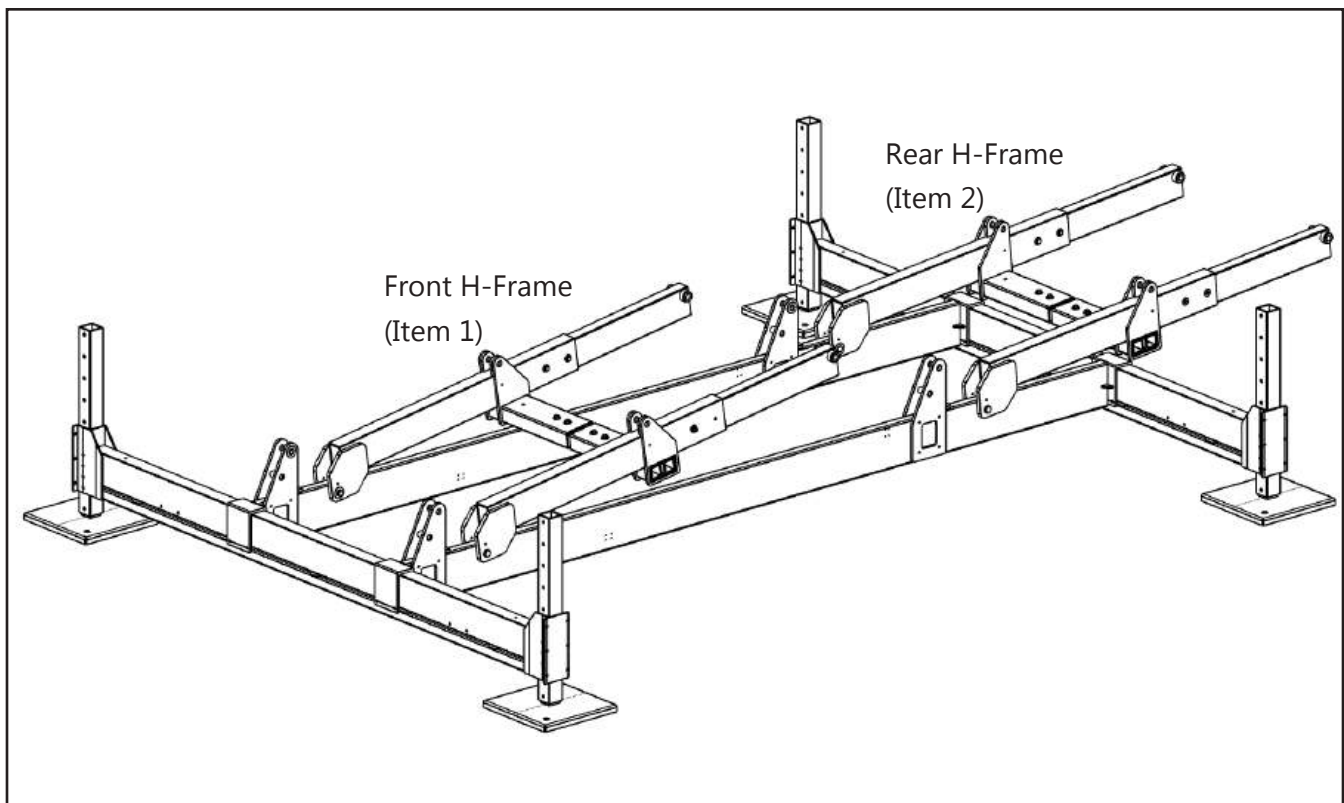

5-C) Use the washers and cotter pins to secure the pin assemblies to the H-Frame assembly.

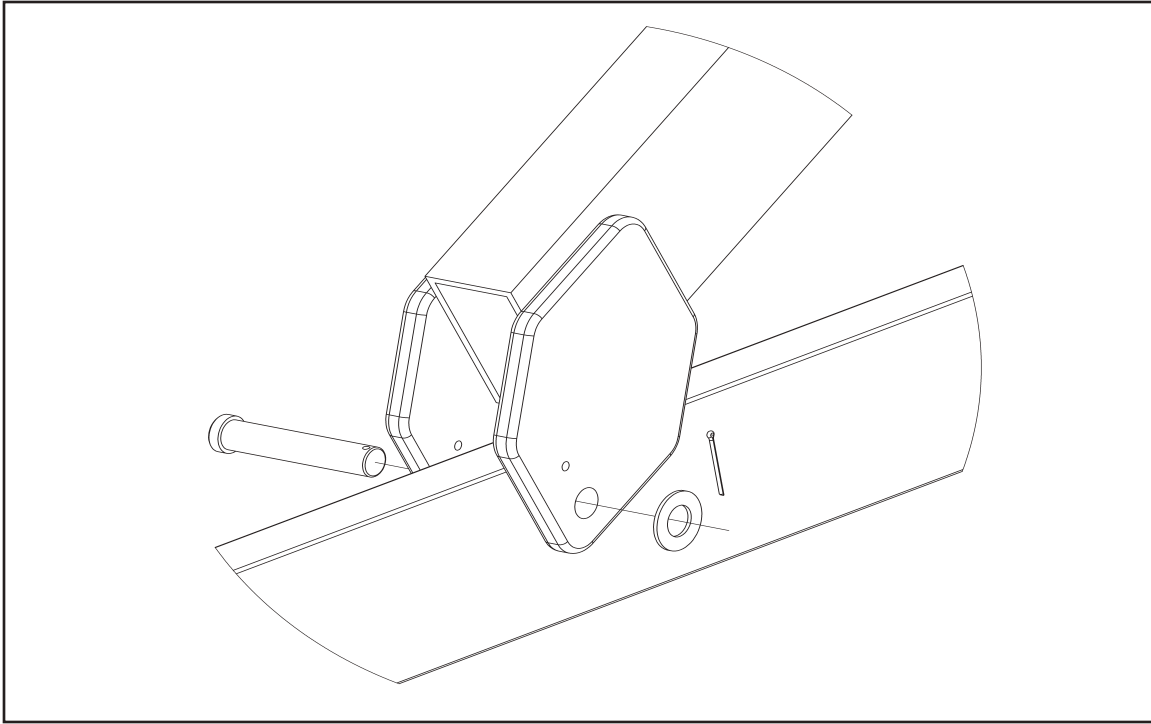

5-D) Slide in the Ø1" - 4 3/4" long pin through to H-frames and beam. The head of the pin should face the outside of the lift. A prying tool may be helpful to align the holes while inserting the pin. A rubber mallet may be used to tap the pin through.

Step 6: Install Cylinders (Item 4)

Hardware required:

- 2x 4" Pin Assemblies
- 2x 3/8"-16 - 1/2" Long Button Head Screws
- 2x 3/8" Lock Washer

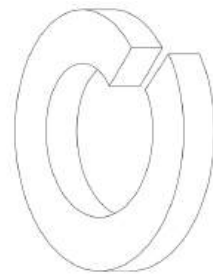
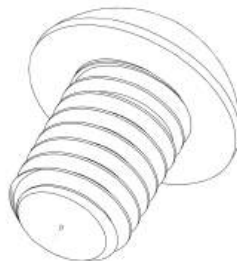
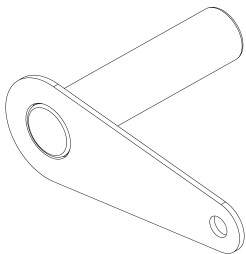

- 2x Ø1" - 3 1/2" Pin
- 2x 1" - Flat Washers
- 2x Cotter Pins
- 8x Plastic Washers

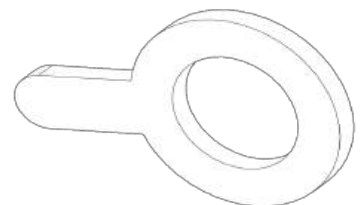
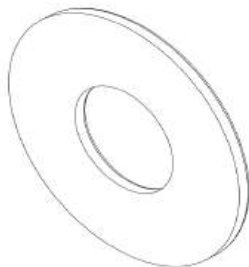
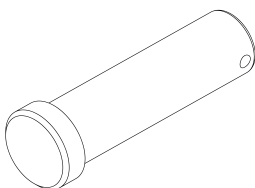

6-A) Apply marine grease to the pins. Use the pin assemblies to attach the hydraulic cylinders (item 4) to the rear H-Frame (item 2). Use the plastic washers to space the cylinders from inside face of the aluminum lugs. Secure the upper pins using the 7/32" allen key to tighten the 3/8" button head screws with lock washers. Use the 1" flat washers and cotter pins to secure the lower pins:

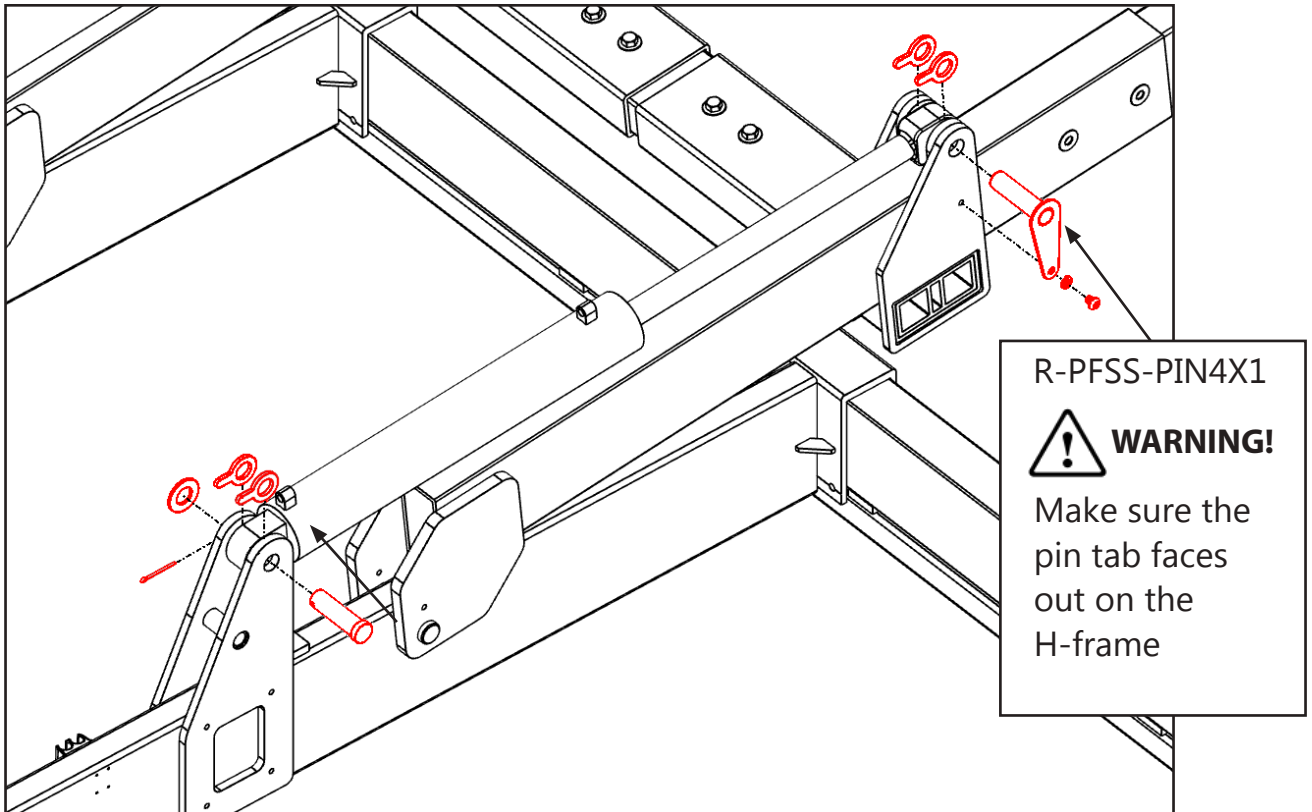

6-B) Repeat step 6-A for the second H-frame

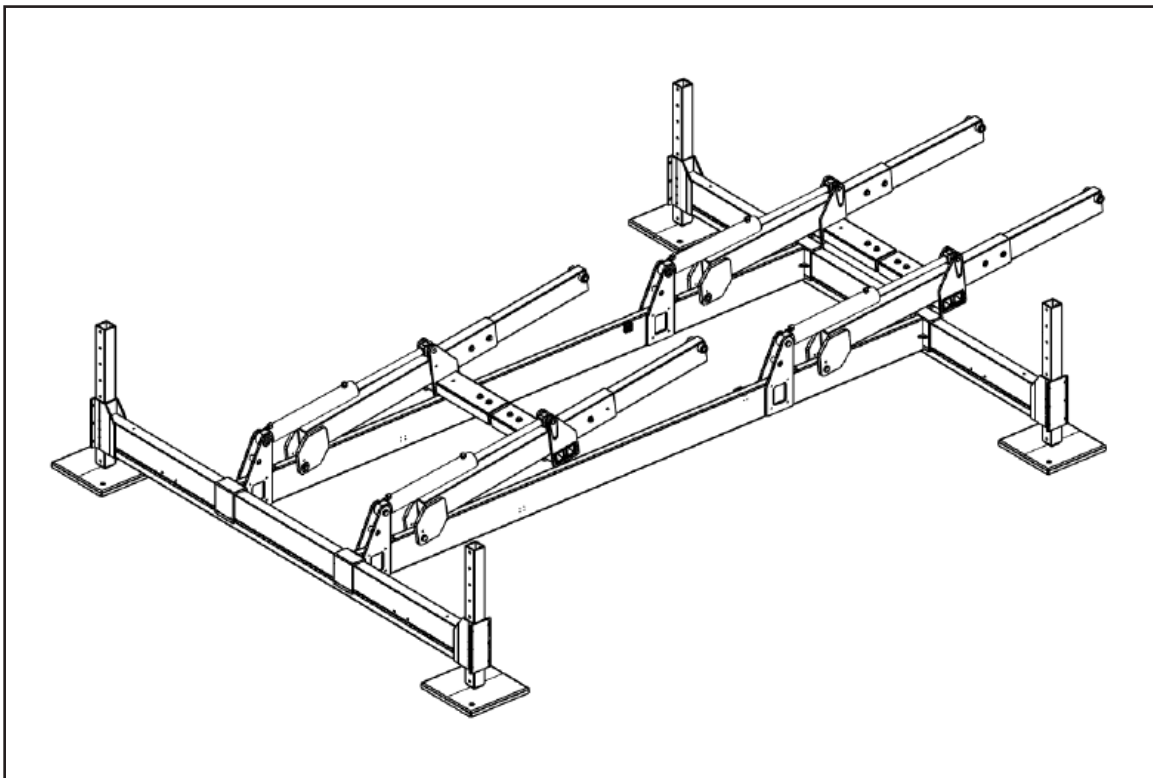

Step 7: Install Bunks (Items 5 and 6)

Hardware required:

- 4x Ø1" - 5 3/4" Long Pin w/ Head
- 4x Cotter Pins
- 4x 1" - Flat Washers

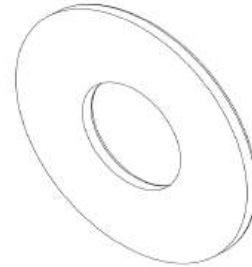
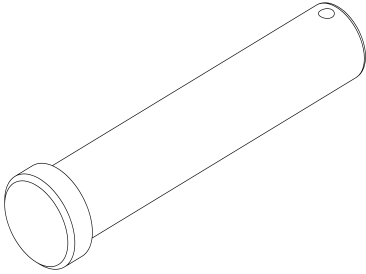

7-B) Place bunks (item 5) on H-Frame assemblies. If you have difficulty installing the bunks in the upright position as shown, try with the lift partially lowered.

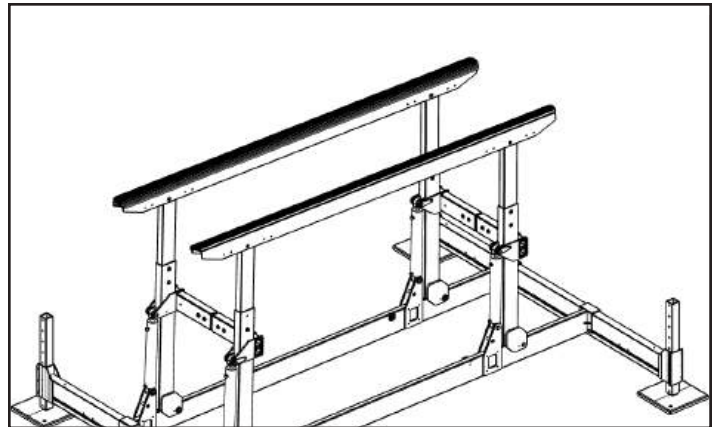
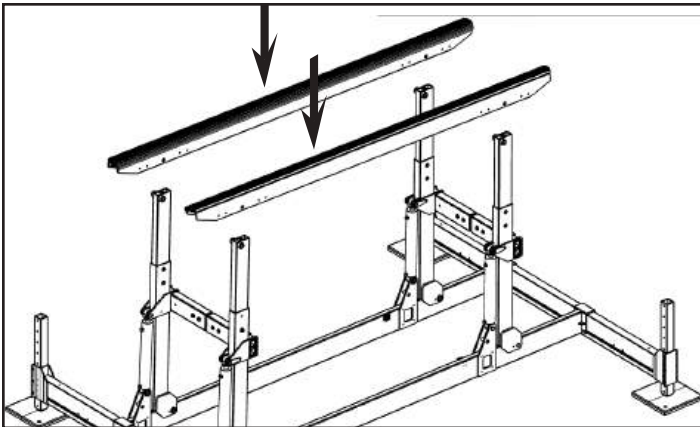

7-C) Apply marine grease to the bunk pins. Install bunk pins to secure bunks to H-Frame. The head of the pins should face the outside of the lift. Use cotter pins and flat washer to secure bunk pins. Bend the end of the cotter pin with the needle nose pliers to secure the pins.

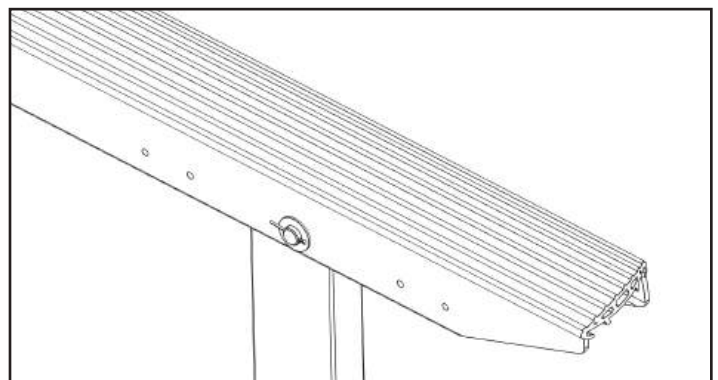
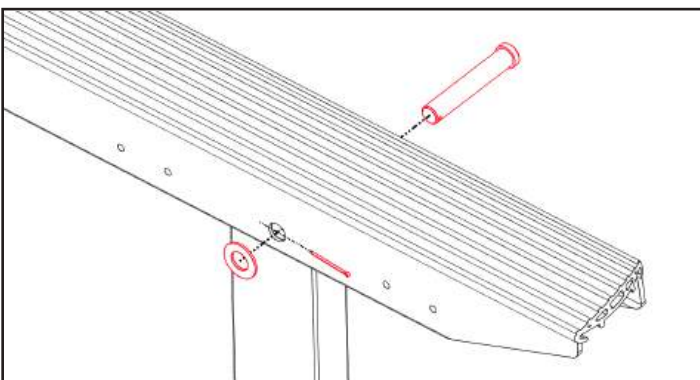

Step 8: Install Guide-Ons (Item 7) (Optional)

Hardware required:

- 8x 3/8"-16 - 6" Long Hex Bolts
- 12x 3/8"-16 - Kep Nuts
- 12x 3/8" - Flat Washers

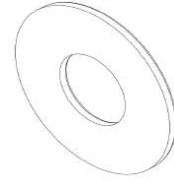
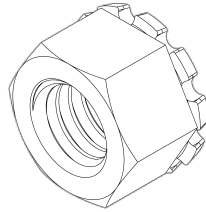
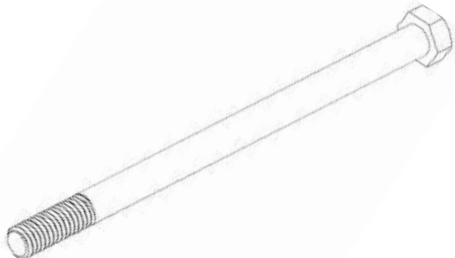

- 4x 3/8"-16 - 4 1/4" Long Hex Bolts

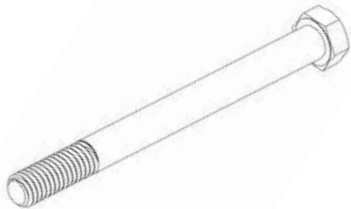

8-A) Assemble guide-on bracket and arm and lift into position:

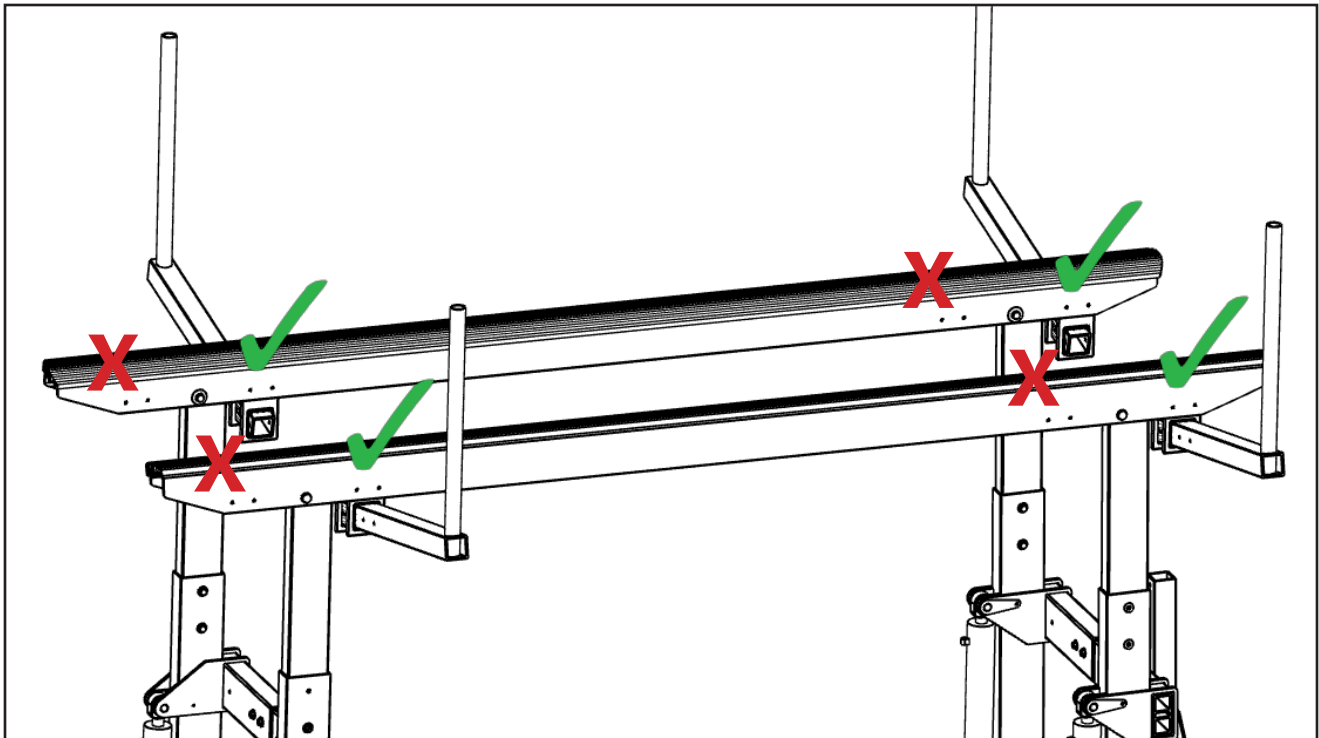

WARNING!

Note the correct locations indicated above by the check marks, incorrect installation can cause damage to the lift frame and/or bunks. If you are uncertain which position to use, lower the lift halfway before installing.

8-B) Bolt guide-ons to bunk using 3/8-16 x 6" long bolts. Tighten the bolts with 9/16" wrench and torque to 23 ft-lbs.

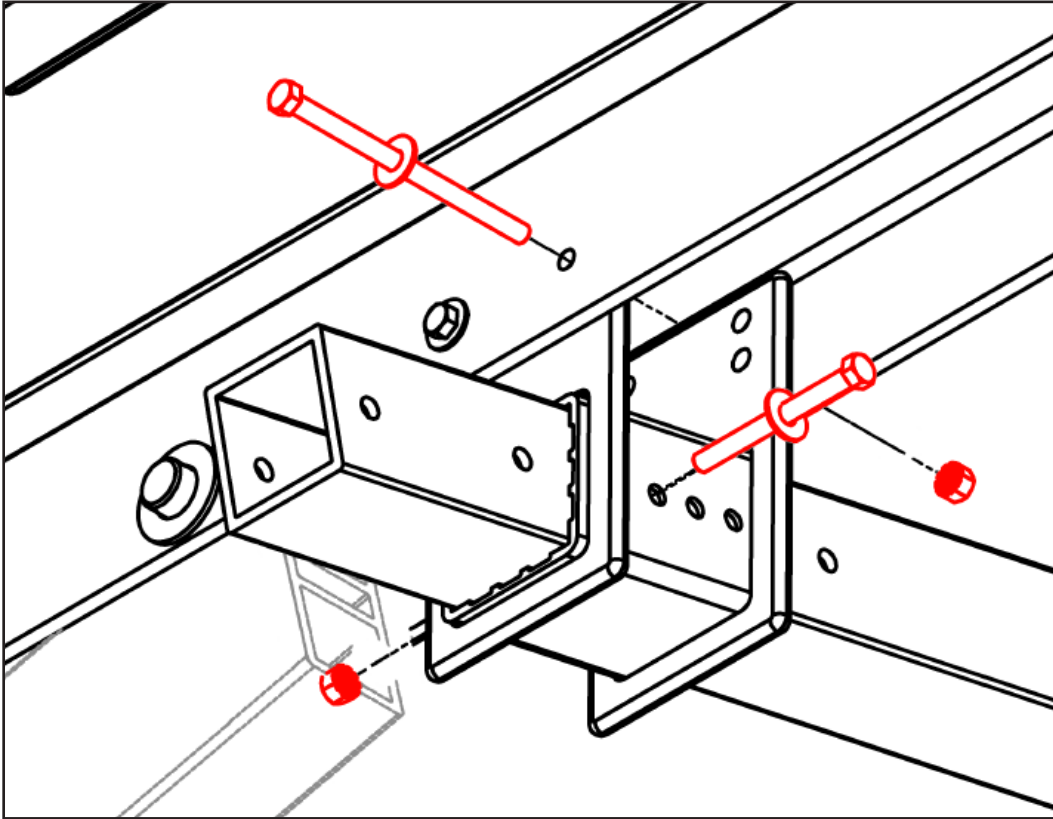

8-B) Bolt the adjustable arm into place using the 3/8-16 x 4 1/4" long bolts. Tighten the bolts with 9/16" wrench and torque to 23 ft-lbs. Position the arms such that they fit the boat width. Place the plastic pipe and guide-on covers over the guide-on tube. The guide-ons are adjustable to different boat widths.

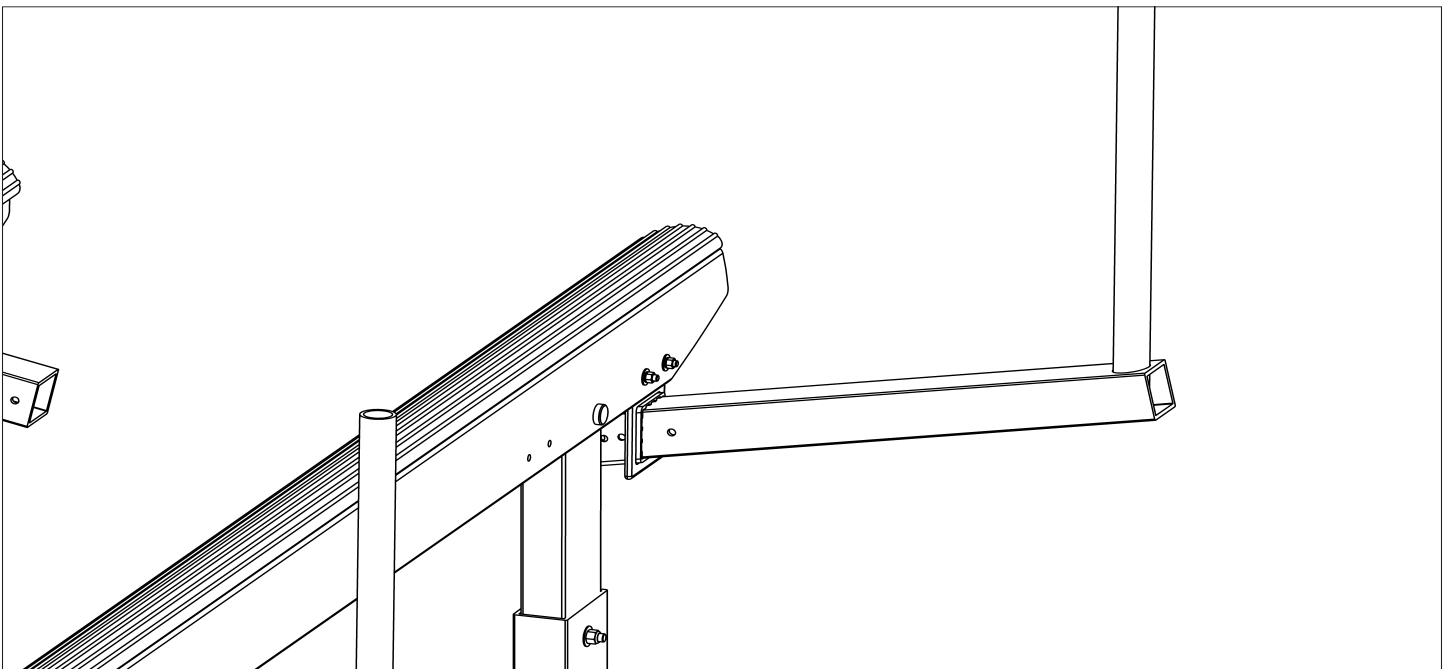

Step 9: Route Hoses to Cylinders

9-A) Mount plastic hose clips to the inside of main beams using #8 self-tapping screws as shown in the image below. A third clip is included to facilitate hose routing and can be mounted to the dock, a pile, or any nearby surface. Ziptie the hoses as shown and route the hoses under the main beam to the power pack box.

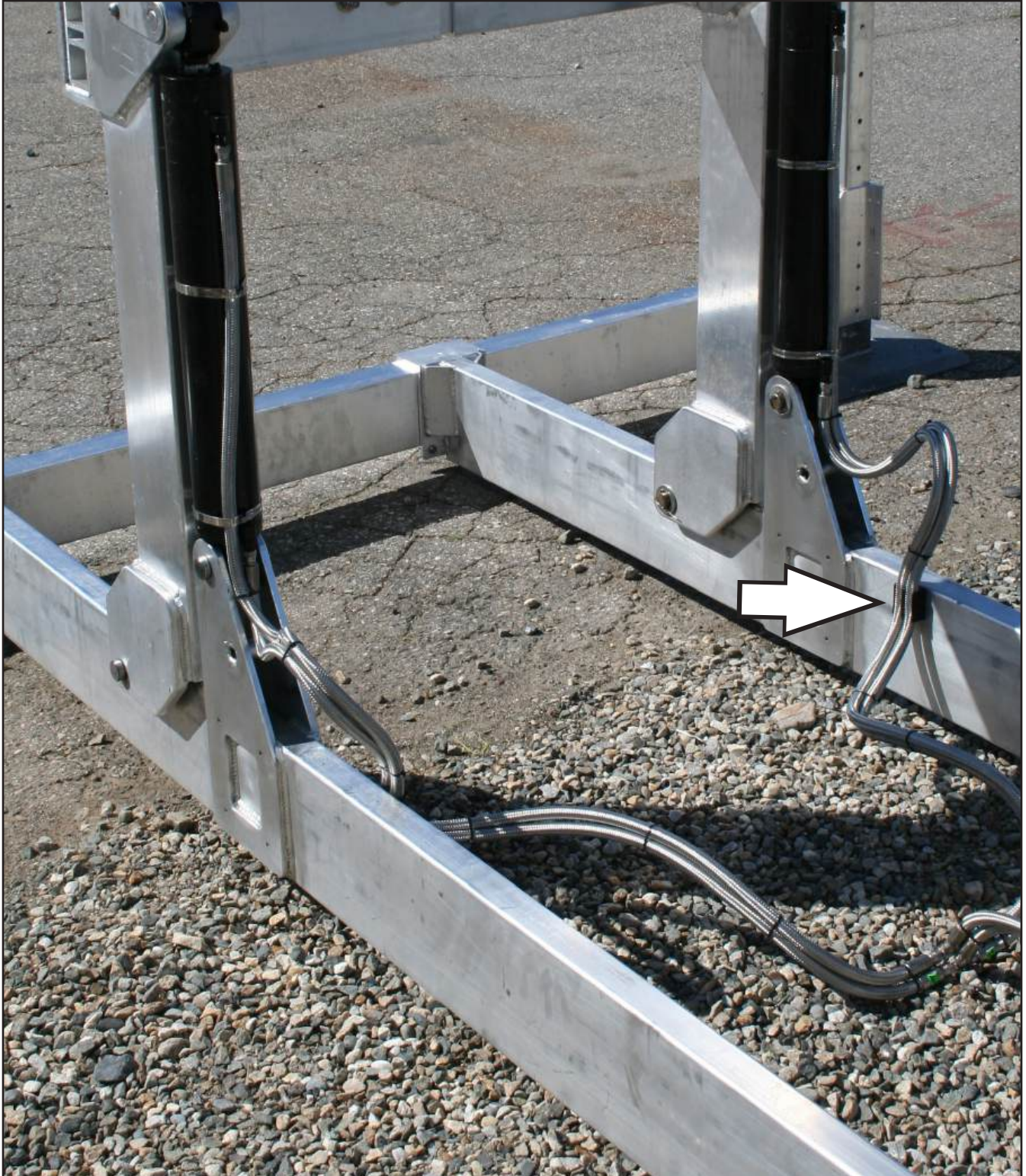

9-B) Ensure that a minimum of 20" length of hose is between the top of the clip to the bottom fitting of the cylinder as indicated by the two arrows. This length is the minimum required for the hoses to not bind when the lift actuates.

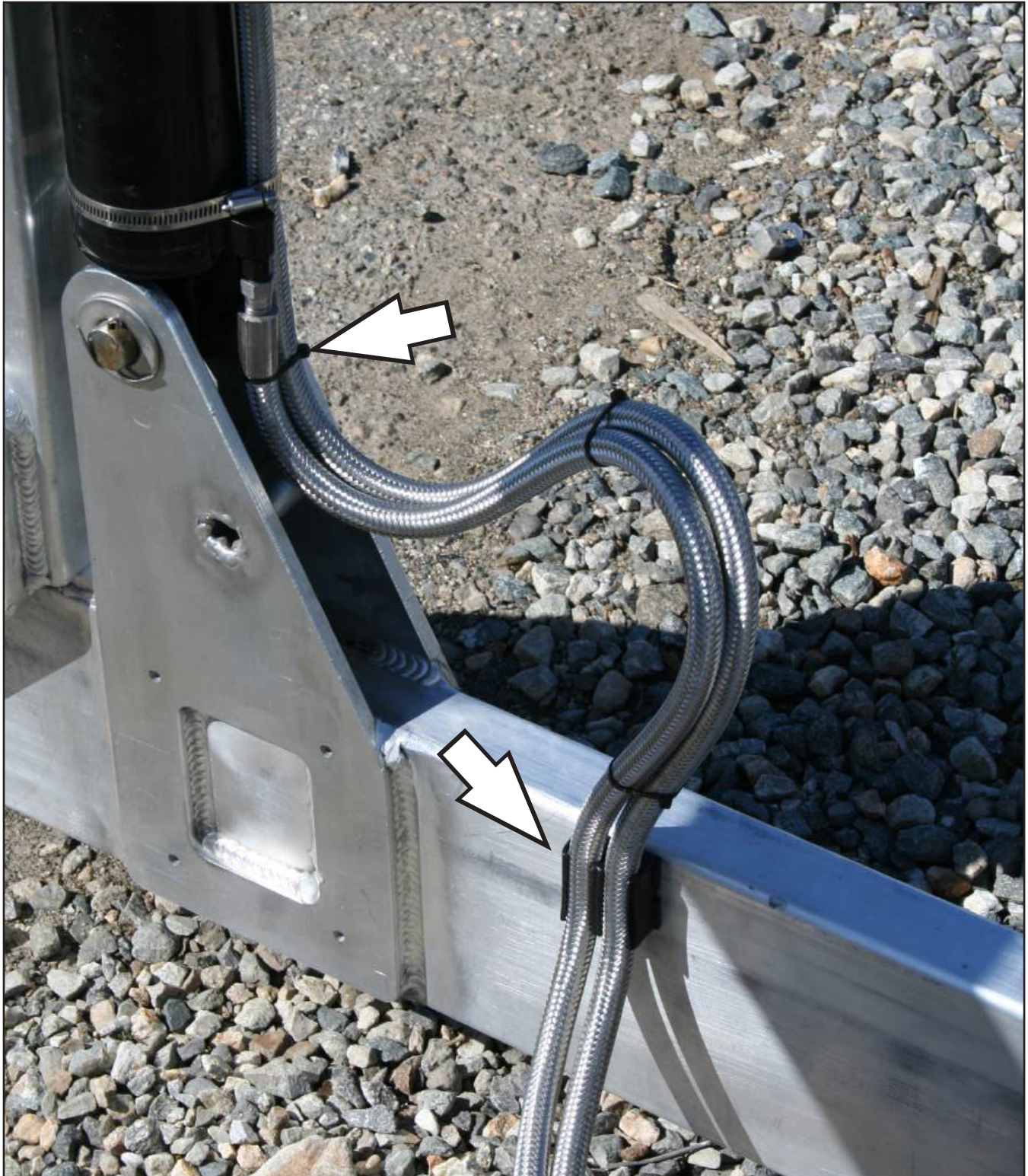

Step 10: Connect Power Pack (Item 16)

10-A) Connect quick-connect hydraulic fittings to power pack. Use the DCP button to depressurize the pump, apply anti-sieze to the quick-connect fittings, then use a 3/4" wrench to hold the male fitting and 1-1/4" wrench to tighten the female quick connect nut.

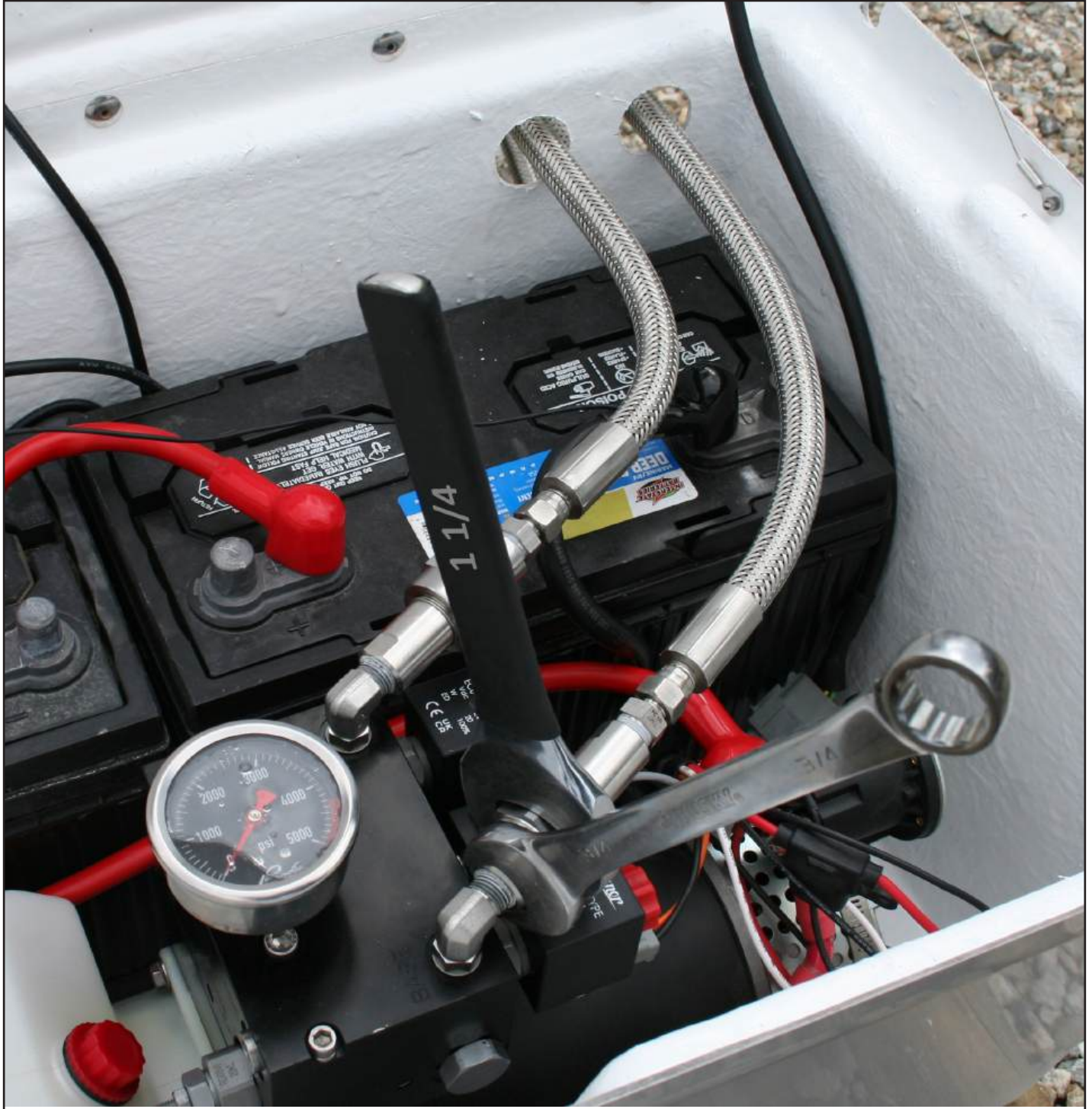

Verify Assembly



CAUTION!

Check that all bolts have been tightened and cotter pins bent.

Be careful when working around hydraulics and battery, wear eye protection.



WARNING!

Check that the hydraulic hose is routed under the main beam and that there are no pinch points.

Gently tug the wires connected to the solar regulator to ensure they are properly affixed. Wires should be clamped against the top of the terminals.

Test the lift initially with no load, actuate it several cycles. Verify that no fittings are leaking and there are no hose pinch points. Apply additional lubrication to pins if squeaky and tighten any leaking fittings.

For 24V systems that use two 12V batteries, ensure they are wired in series and the charging wires are connected according to the following diagram:

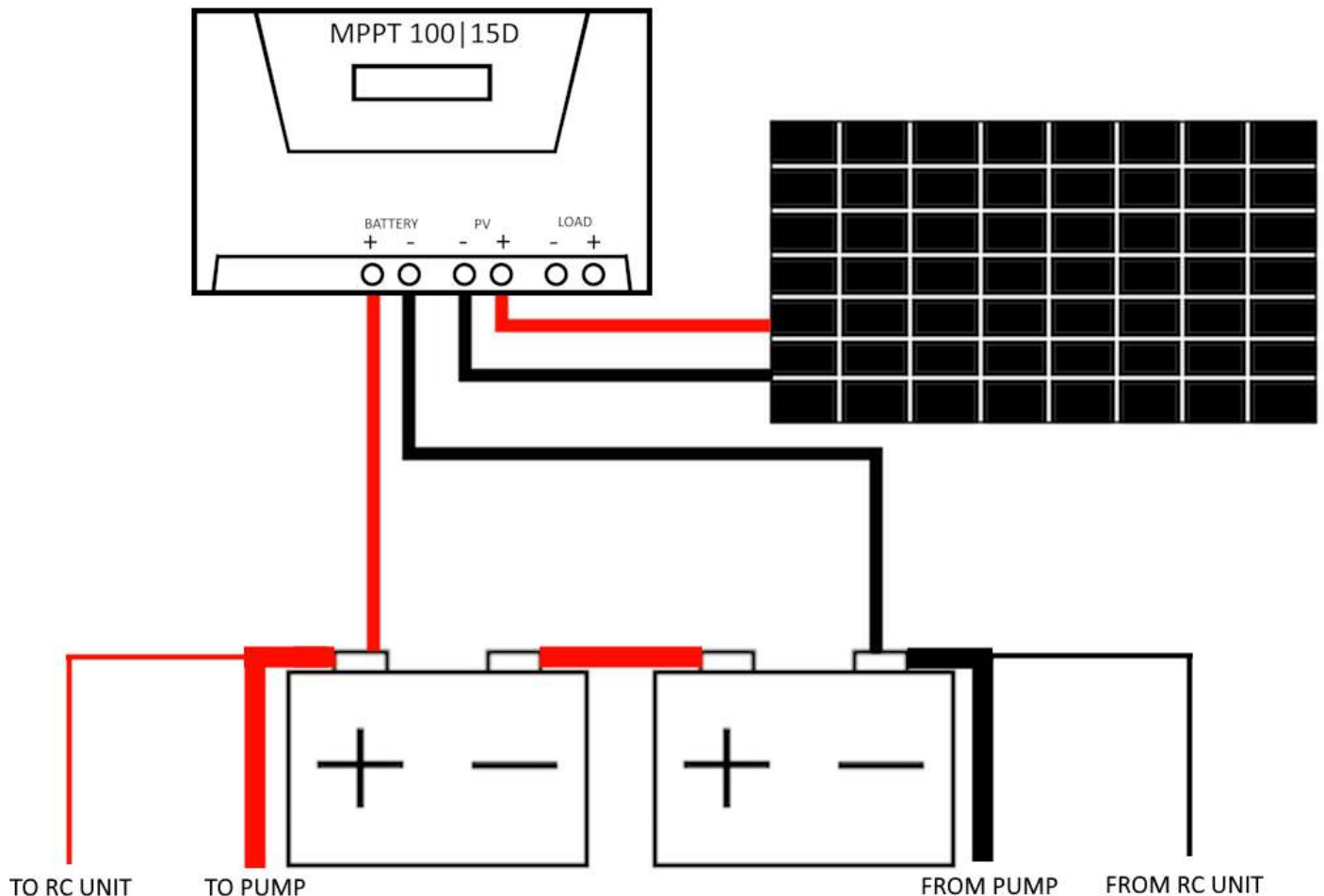

**WARNING!**

Only install lift during good conditions, adverse conditions may pose a hazard during installation that may cause injury, death or property damage.

Never exceed the maximum rated lift capacity. Exceeding the capacity may cause the lift to tip or fail causing injury, death or property damage.

Placing the Lift

Your lift should be installed at a depth corresponding to the hull draft of your boat. Measure the depth from the water line to the keel and add 2 inches. When installing your lift, make sure the H-frame cross beam is at least this depth below the low water line. The lift height above the water should be maximized to reduce the chances of waves contacting your watercraft. To launch your lift, float your lift to the installation location, or roll your lift if a wheel kit is installed

For a float installation, 250 lb floatation bags should be attached to the front and rear H-Frames of the lift. A certified diver may be required for this type of installation depending on depth. Prior to launch, the legs should be bolted at their lowest height, the power pack disconnected, and the lift lowered. Put the lift into the water at the approximate installation position and remove the leg bolts to allow the legs to drop to the water bottom. Re-bolt the legs at the closest location (See Step 3 for instructions) and reconnect the hoses to the power pack. The lift can now be leveled

For a roll-in installation, make sure the wheel kit is properly installed and firmly attached. Lower the lift fully so that the wheels support the entire lift. At this point, the lift should roll freely. Disconnect the powerpack, then roll the lift into the water. When the lift reaches the installation location, reconnect the powerpack and raise the lift. Finally, remove the wheels from the wheel pockets and level the lift.

Leveling the Lift

Use a tape measure to measure from the top of the end beams at each of the 4 corners to the surface of the water. All measurements should be within 2 inches of each other. If they are not, adjust the leg height (legs are adjustable in 2 inch increments) at the corner that is more than 2 inches different from the other corners. After leveling, it can be helpful to place any nearby large rocks on top of the foot pads to prevent shifting.

**CAUTION!**

Failure to level the lift before operation can result in the lift becoming unstable during operation. This can lead to unbalanced loading, damage to the lift, or the lift toppling over. Always make sure the lift is level whenever it moves or settles.

Install the Leg Braces (Deep Water)

If your legs are longer than 7 feet, install the optional deep water leg braces as per the leg brace installation instructions (not included). Finish adjusting legs prior to installing leg braces.

Secure the Foot Pads (Optional)

If your area sees high waves or is on a steep slope, you may want to consider installation of rebar anchors (not included) to anchor the foot pad positions. Hammer a 2ft-4ft piece of 1/2" rebar through the holes in each foot pad into the ground.

Replace the Shipping Cap with the Breather Cap

Paradise boat lifts ship with an airtight cap on the reservoir to prevent hydraulic oil spills in transit. However, these caps are unsuitable for operation as they do not allow airflow into and out of the reservoir as oil is pumped to the cylinders. The breather cap, included with your lift in the accessory box, allows this airflow and is required for operation.



CAUTION!

Operating the lift with an airtight reservoir cap can cause severe overpressure or underpressure in the reservoir leading to a rupture. Never operate the lift with an airtight reservoir cap.



Smaller, airtight shipping cap



Larger, permeable breather cap

Lift the Boat for the First Time

Begin by positioning the boat with the center of gravity in the middle of the bunks (this typically has the transom 12-18 inches past the back of the lift). Raise the lift slowly until the bunks hold the boat. Observe the lift for stability. Continue lifting the boat until it is 1 foot above the water, again check the lift for stability and that it remains level. If stable, continue lifting the boat until it is fully lifted and over centre. Check the lift again for stability and level. Remove the boat from the lift, check the level of the lift as per the previous instructions and adjust as necessary. The weight of the boat can cause the lift to shift. Check and adjust the lift level 2 weeks after this initial use and again each season, as the lift may settle over time under load. You may hear a gurgling sound from the pump box during the first few lifts as air escapes the system.



CAUTION!

The lift may settle or be unstable during initial use. Ensure everyone is a safe distance away during the initial lift to ensure no one is crushed should the lift topple over.

Your Paradise Hydraulic Boat lift comes with two remote controls, shown to the right. The operation of the remote controller is described below:

Start Button: Starts the lift session, this must be pressed prior to actuating the lift, after the stop button is pressed or after 5 minutes have elapsed since the controller was used.

Stop Button: Ends the lifting session. The up and down buttons are disabled when this is pressed.

Up Arrow: Actuates the lift upwards.

Down Arrow: Actuates the lift downwards.

Light: Actuates the light kit if optional. This button is latching (light remains on when actuated on or off)

If your remote is not working, please check that the 2x AAA batteries are not dead.

Inside the power pack box, the lift also contains a hard wired controller, the operation of the controller is described below:

Enable Button: Enable button must be pressed and held to actuate the lift or lights.

Up Arrow: Actuates the lift upwards when the enable button is held.

Down Arrow: Actuates the lift downwards when the enable button is held.

Light: Actuates the light kit if optional when the enable button is held. This button is latching (light remains on when actuated on or off).

DCP: Depressurizes the hydraulic system.

Pairing the remote:

1. As soon as the controller is powered, the yellow LED of the device starts to flash slowly.
2. Within 15 seconds:
 - Press START on the handheld to normally activate the device
 - Then keep any three keys of the handheld pressed down simultaneously (excluding the STOP) until the yellow LED on the handheld flashes three times.
3. After the triple flash, the handheld/controller system is paired and will remain valid until a new pairing is performed.



**WARNING!**

Paradise Dock & Lift recommends your lift be inspected annually by a qualified dealer or installer.

Battery Maintenance

Battery issues are the most common reliability issues encountered with hydraulic boat lifts. The following tips pertain to battery maintenance:

- Check your battery health every 3 months. Batteries should measure at least 12.5V with at least a 75% state of charge, or at least a 75% reading on a battery hydrometer.
- If a replacement battery is needed, a 12V group 31 marine battery is recommended. Any replacement battery must have at least 160AH capacity and 500CCA current delivery.
- It is recommended that the battery state of charge not drop below 50% capacity, as a trickle or solar charge will have difficulty restoring the battery from this state.
- The battery may require a trickle charge during the off season or a boost at the beginning and end of the boating seasons.
- If your battery is not staying charged: install an AC trickle charger, move the solar panel to a sunnier location, boost your battery mid-season, or check your battery water levels and top up as necessary with distilled water.

Storage Tips

The following suggestions pertain for when your lift is not in use:

- When storing your boat, the lift should always be in the fully “up over centre” position. This ensures that if your lift has a hydraulic leak the boat will not drop.
- When not in use, it is recommended that the lift be stored upright so that the bunks remain clean and the cylinder shafts remain protected from the elements.
- During winter storage, it is recommended that the lift should be removed from the water if the water freezes. Paradise is not be liable for damage to lifts left in freezing or frozen water, or left in water over winter.
- Ensure that the lift is at a height such that waves do not touch the hull when the boat is stored. Waves may cause damage to the boat or dislodge the boat from the lift.
- It is recommended that the batteries be stored indoors during winter months or prolonged periods without use. Take a picture of the batteries to remember where each cable is connected, then disconnect the cables from the battery terminals starting with the negative, being careful not to touch the battery terminals with any cables. Bring the batteries indoors and store until you are ready to use the lift again. Put the cables back (exactly as they were/according to the wiring diagram), starting with the negative.

Issue	Potential Solution
<ul style="list-style-type: none"> Battery terminals hot. 	<ul style="list-style-type: none"> Ensure battery terminals are tightened properly, ensure no corrosion or debris is built up on terminals.
<ul style="list-style-type: none"> Battery not staying charged. 	<ul style="list-style-type: none"> Ensure battery fluid level is topped up, plug in trickle charge or solar charger, ensure solar panel is getting sunlight.
<ul style="list-style-type: none"> Remote control not working. 	<ul style="list-style-type: none"> Replace batteries, try using remote at a closer location. Verify that the lift operates with the hard wired controller. Electromagnetic interference could disrupt signal.
<ul style="list-style-type: none"> Lift does not actuate with hard wired controller. 	<ul style="list-style-type: none"> Check battery voltage. Verify that all wires are plugged in. Check that the hydraulic pump motor is actuating.
<ul style="list-style-type: none"> Hydraulic hoses are difficult to connect. 	<ul style="list-style-type: none"> Check for debris on threads. Use a wrench to connect quick disconnects. Depressurize the system as described in Step 10 of Assembly Instructions.
<ul style="list-style-type: none"> Hydraulic fluid in power pack box. 	<ul style="list-style-type: none"> Fluids may have overflowed due to air in system. Check all fittings and tighten as necessary.
<ul style="list-style-type: none"> Lift is noisy/squeaky when operating. 	<ul style="list-style-type: none"> Tighten all bolts and re-lubricate all pins with marine grease.
<ul style="list-style-type: none"> Gurgling sound in reservoir 	<ul style="list-style-type: none"> Make sure the lift has enough fluid. Fluid level should be measured with lift in upright position. Only add compatible fluid.
<ul style="list-style-type: none"> RC unit won't work 	<ul style="list-style-type: none"> Check that RC unit fuse is good. Shown in picture below:

Contact your dealer for compatible hydraulic fluid
For detailed troubleshooting instructions, consult the Paradise Troubleshooting Guide.



WARRANTY



PARADISE DOCK & LIFT INC.

15 YEAR LIMITED WARRANTY

Paradise Dock & Lift Inc. ("Paradise") warrants to the original purchaser that its parts for residential use are free from defects in materials and workmanship as stated in this Limited Warranty during the Warranty Period as identified herein. The Warranty Period begins on the date of purchase as shown on its receipt or invoice. The Limited Warranty is not transferable or assignable. Any product used commercially or for non-residential use is limited to a 1-year warranty.

Dock Frames: Roll-In Dock, Sectional Dock, Floating Docks – 15 Year Warranty Period

Paradise will provide replacement parts, on a non-pro-rated basis, for five (5) years from the date of purchase for these items if they are found to be defective in workmanship. After this 5-year parts warranty, an additional ten-year pro-rated warranty covers these components as shown below. Aluminum decking is warrantied for 5 years, the warranty does not include paint fading, paint wear, scratches, and denting. Third-Party components carrier their respective warranty from their manufacturer.

The pro-rated schedule of these items is as follows:

Year After Purchase	Consumer Portion of Current Retail Price	Year After Purchase	Consumer Portion of Current Retail Price
6	5% Parts Only	11	50% Parts Only
7	10% Parts Only	12	60% Parts Only
8	20% Parts Only	13	70% Parts Only
9	30% Parts Only	14	80% Parts Only
10	40% Parts Only	15	90% Parts Only

Boat Lift Frames – 15 Year Warranty Period

Paradise will provide replacement parts, on a non-pro-rated basis, for five (5) years from the date of purchase for these items if they are found to be defective in workmanship. After this 5-year parts warranty, an additional ten-year pro-rated warranty covers these components as shown below. This is exclusive of the hydraulics, hoses and powerpack, which parts only have three (3) years coverage from the date of purchase if found to be defective in workmanship.

The pro-rated schedule of these items is as follows:

Year After Purchase	Consumer Portion of Current Retail Price	Year After Purchase	Consumer Portion of Current Retail Price
6	5% Parts Only	11	50% Parts Only
7	10% Parts Only	12	60% Parts Only
8	20% Parts Only	13	70% Parts Only
9	30% Parts Only	14	80% Parts Only
10	40% Parts Only	15	90% Parts Only

Dock Accessories, Boat Lift Accessories, Wheel Kits & Tires – 3 Year Warranty Period

Defects in the material and workmanship of certain accessories of Paradise dock and boat lift systems are covered under a three (3) year pro-rated warranty. Items covered include wheel kits, plastic wheels/tires, benches (except cedar boards), bumpers, dock stairs, ladders, dock furniture/tables, kayak/canoe rack/ flagpole, shore-end ramps (except cedar boards), support poles, poly decking, hammocks, guide-ons, bow-stops, canopies, walkways and powerpack brackets.

This Limited Warranty is for the repair or replacement of parts only. If you discover a parts defect, you must notify your local Paradise dealer or distributor, in writing, of any claim under this Limited Warranty. Your written notification must include proof of purchase which includes the original name, address, and details about the warranty claim. At Paradise's request for confirmation of defect, you are responsible for returning the part to your local Paradise's dealer or distributor. The replacement part shall be warranted for the balance of the Warranty Period remaining on the original part.

AFTER RECEIVING NOTIFICATION OF THE DEFECT, PARADISE WILL, AT ITS DISCRETION, REPAIR, REPLACE, OR, IF PARADISE DETERMINES IN ITS SOLE DISCRETION THAT REPAIR OR REPLACEMENT IS NOT FEASIBLE, REFUND THE PURCHASE PRICE OF THE PART FOUND ON EXAMINATION BY PARADISE TO BE DEFECTIVE UNDER NORMAL USE AND SERVICE. IN ORDER TO ALLOW PARADISE AN OPPORTUNITY TO ASSESS THE CONDITION OF THE PART FOR WHICH A WARRANTY CLAIM IS MADE, YOU SHALL PROVIDE REASONABLE ACCESS TO THE PART TO PARADISE AND/OR ITS AGENTS, WHICH INCLUDES PARADISE DEALERS OR DISTRIBUTORS. TO FACILITATE THE PROMPT ASSESSMENT OF YOUR WARRANTY CLAIM, PARADISE MAY, FROM TIME TO TIME, REQUIRE THAT YOU PROVIDE ADDITIONAL DOCUMENTATION, PHOTOGRAPHS AND OTHER INFORMATION. FAILURE TO PROVIDE THE FOREGOING WITHIN A REASONABLE TIME FROM THE DATE OF REQUEST BY PARADISE WILL INVALIDATE YOUR LIMITED WARRANTY.

Routine maintenance and checking for loose connections or damaged parts must be performed on a monthly basis. Paradise shall not warrant and cover any damage caused by circumstances outside the reasonable control of Paradise, or defect in the parts directly or indirectly, or wholly or partly attributable to:

- (a) the misuse, negligence, abuse, neglect, improper installation, including any damage to the parts resulting from alterations or modifications made by any person not authorized by Paradise;
- (b) exposure of the parts to snow or ice, salt water use, natural expansion or contraction of parts caused by weather conditions, severe weather conditions, storms, vandalism, being hit by another a watercraft, terrorism, or acts of God;
- or
- (c) accident, overloading, power surges, corrosion, or operation of the parts on circuits or voltage other than those specified to the parts.

THIS LIMITED WARRANTY IS YOUR EXCLUSIVE WARRANTY AND REPLACES ALL OTHER WARRANTIES OR CONDITIONS, EXPRESS OR IMPLIED, INCLUDING BUT NOT LIMITED TO, THE IMPLIED WARRANTIES OR CONDITIONS OF MERCHANTABILITY AND FITNESS FOR A PARTICULAR PURPOSE.

Some provinces or jurisdictions do not allow limitations on how long an implied warranty lasts, so the above duration may not apply to you.

IN NO EVENT SHALL PARADISE, ITS SUBSIDIARIES, PARENT, SUPPLIERS, DEALERS, DISTRIBUTORS, RESELLERS OR SERVICE PROVIDERS BE LIABLE FOR: (i) third party claims against you for damages; or (ii) special, incidental, indirect or consequential damages, including lost profits, business revenue, goodwill or anticipated savings, these exclusions apply even if paradise has been advised of the possibility of these damages and even if any remedy fails of its essential purpose. Subject to this paragraph, any claim for damages for breach of warranty shall be limited to the purchase price of the part.

NOTHING IN THIS LIMITED WARRANTY AFFECTS STATUTORY RIGHTS THAT CANNOT BE WAIVED OR LIMITED BY THIS LIMITED WARRANTY.

4 CYLINDER LIFT FASTENER LIST

ALL FASTENERS PICTURED ARE REAL SIZE

1/2" 3/8"-16 BUTTON HEAD BOLT
R-UFSS-3_8X0.5-B

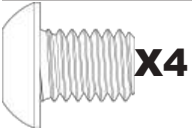

X4

1" #8 SELF TAPPING SCREW
R-UFSS-SCRW-8-1



X10

2" COTTER PIN
R-PFSS-2-CP

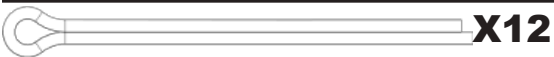

X12

3/8" LOCK WASHER
R-UFSS-WSHR-3_8-L



X4

HOSE CLIP
R-HOSECLIP

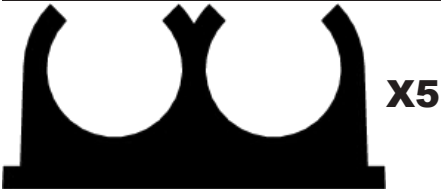

X5

1/2" NYLOCK NUT
R-UFSS-1_2-13-NYLOC



X16

3/8" KEP NUT
R-UFSS-3_8-16-KEP



X20

3/8" FLAT WASHER
R-UFSS-WSHR-3_8-F

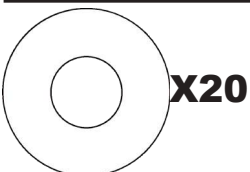

X20

UHMW CYLINDER WASHER
R-UFSS-WSHR-UHMW

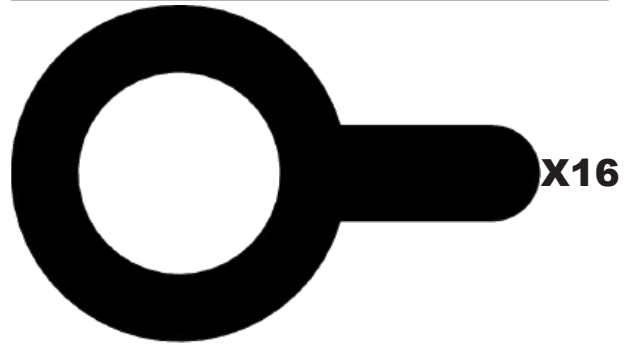

X16

1" FLAT WASHER
R-UFSS-WSHR-1-F

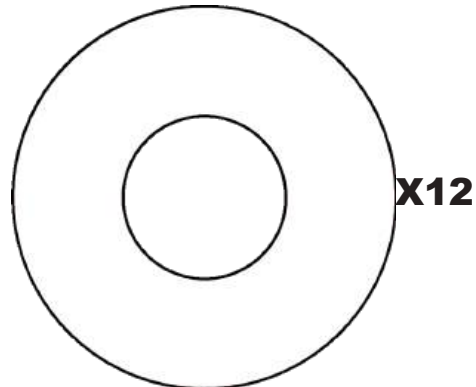

X12

PUMP BOX GROMMET
R-GROMMET

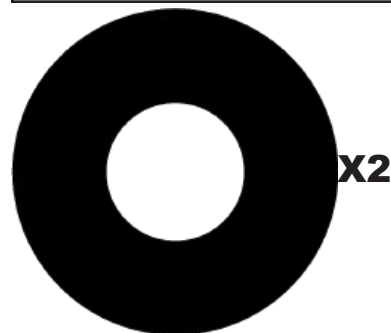

X2

1/2" FLAT WASHER
R-UFSS-WSHR-0_5-F

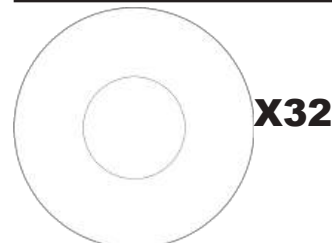

X32

6" BUNK PIN
R-PFSS-BPIN6X1-F

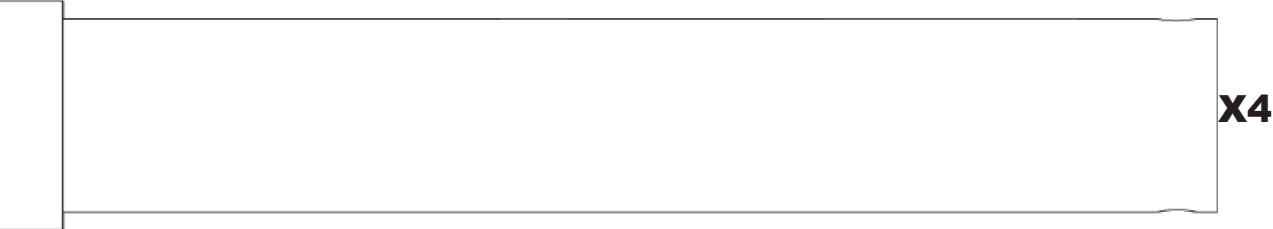

5" H-FRAME PIN
R-PFSS-PIN5X1-F



3 1/2" CYLINDER PIN
R-PFSS-PIN3_5X1-F



4" TEARDROP CYLINDER PIN
R-PFSS-PIN4X1

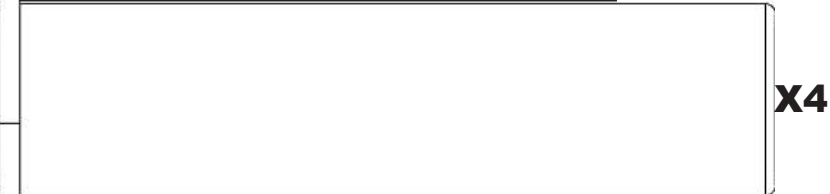

4 1/2" 1/2"-13 HEX HEAD BOLT
R-UFSS-1_2-13X4-1_2-H

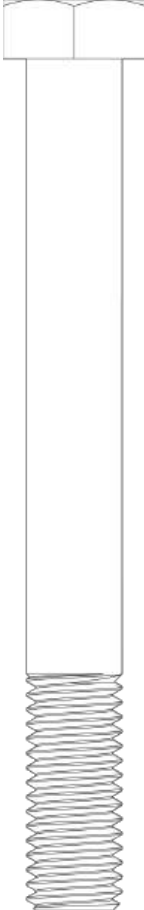

3 3/4" 3/8"-16 HEX HEAD BOLT
R-UFSS-3_8-16X3.75-H



4 1/2" 3/8"-16 HEX HEAD BOLT
R-UFSS-4X3_8-16X4-1H



4" 1/2"-13 HEX HEAD BOLT
R-UFSS-1_2-13X4-H





Paradise Dock & Lift Inc.

4311A 25 Ave.

Vernon, BC, Canada

V1T 1P5

www.paradisedocklift.com

info@paradisedocklift.com

1-888-411-3625

SPECIFICATIONS & INSTRUCTIONS SUBJECT TO CHANGE
WITHOUT NOTICE.

COPYRIGHT © 2024 PARADISE DOCK & LIFT INC.